

REV.	DESCRIPTION	DATE	DRAWN	APPROVED
A1	DWG.REL	2016/10/7	FANG	YANG

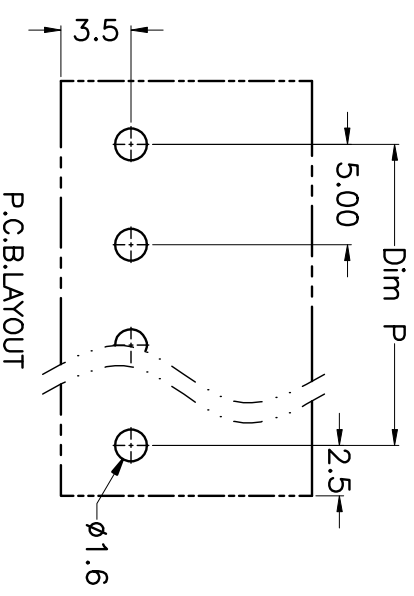
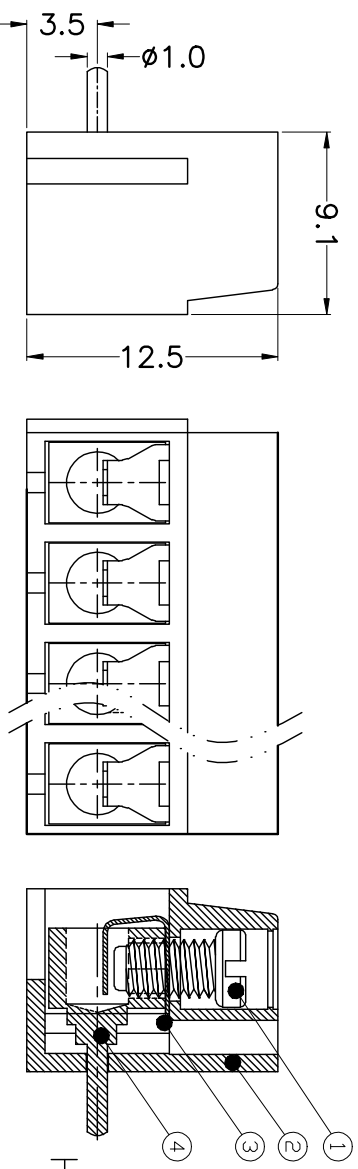
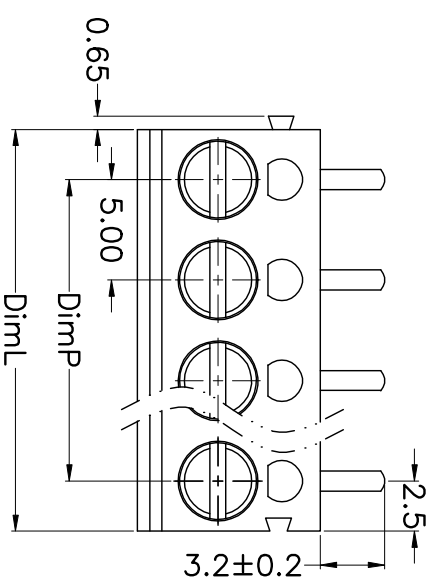

N=Number of Poles
Dim P=(N-1)×5.00
Dim L=N×5.00

Poles/Dim	Dim P	Dim L
2-6P	±0.10	±0.15
7-12P	±0.20	±0.20
13-18P	±0.25	±0.30
19-24P	±0.30	±0.40

GENERAL TOLERANCE	ANGLE TOLERANCE	TOLERANCE
X: ±0.5 .X: ±0.3 .XX: ±0.1	X: .X° .X': .X° .XX': ±1'	±5° ±3° ±1'
DRAWING TYPE	CUSTOMER	
SCALE	1:1	SHEET 1 OF 1
DRAWING NO.	XP0012016-xxxx	

- Material
 - ①Screws : M3.0 steel, Zinc plated,
 - “-” slot type
 - ②Housing : PA66, UL94V-0
 - ③Reed : Phosphor bronze, Ni plated or stainless steel
 - ④Pin header : Brass, Tin plated

- Electrical

UL	IEC
Rated voltage : 300V	250V
Rated current : 12A	24A

Insulation resistance: 500MΩ/DC500V
Withstanding Voltage : AC2000V/1min
Wire range: 22-14AWG 2.5mm²

- Mechanical

Operating temperature: -30°C~+120°C
Soldering temperature: 250°C±5/5sec
Torque: 0.5N.m (4.43lb.in)
Strip length: 4.5-5mm

HOW TO ORDER

KF300 R - 5.0 - XXP - 1 X - XXXXX

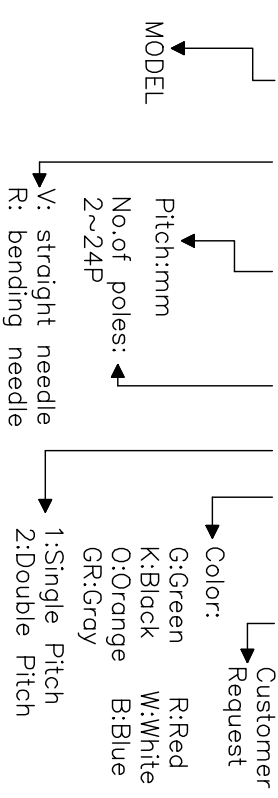

PROJECTION	TITLE
UNITS	KF300R-5.0-XXP
SHEET SIZE	A4
SERIES	KF300R

KF 慈溪市凯峰电子有限公司
KAIFENG ELECTRONIC CIXI KAIFENG ELECTRONIC CO.,LTD