

Data sheet

Commercial Art.No.: 78.003.0253.0

Modular insert FLE BUC 2 5K

Modular connector system 2 pole female insert, 2,8kV/20A, crimp connection, turned contacts

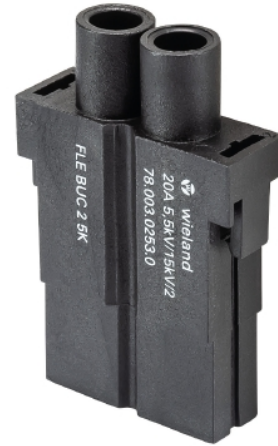

| | |
|--------------------|---------------|
| Commercial Art.No. | 78.003.0253.0 |
| EAN | 4015573782280 |
| Order Unit | 5 |

Certificates / Approvals



Technical data

General

| | |
|--|---------------|
| Model | Female insert |
| Inflammability class of insulation material acc. with UL94 | V0 |
| Color | black |
| Pollution degree | 2 |
| Modular version | yes |
| Operating temperature range min. | -40 °C |
| Operating temperature range max. | 120 °C |

Connection Data

| | |
|--|-------|
| Connection type | Crimp |
| Number of poles | 2 |
| Plus switching contacts | 0 |
| Number of pole for rated current 2 | 0 |
| Number of pole for rated current 3 | 0 |
| Total number of poles (without ground contact) | 2 |
| With wire protection | No |
| Protective contact | No |

Technical Data UL/CSA

| | |
|-----------------------------------|------|
| Rated voltage according to UL/CSA | |
| Rated current according UL | 20 A |
| Rated current according CSA | 20 A |

| | |
|--|---------------------|
| Min. conductor cross section flexible wire | 0.5 mm ² |
| Max. conductor cross section flexible wire | 4 mm ² |
| Conductor cross section flexible AWG wire | 20-12 AWG |

Model

| | |
|--------------|----|
| With housing | No |
|--------------|----|

Contacts

| | |
|------------------|---------------|
| Contact material | See contacts |
| Surface | Silver-plated |

Technical Data DIN EN 61984

| | |
|---------------------------|--------|
| Nominal voltage | 5500 V |
| Rated voltage face/ground | 5500 V |
| Nominal current | 20 A |
| Rated impulse voltage | 18 kV |

Classification

| | |
|------------|----------|
| ECLASS 11 | |
| ECLASS 8.1 | 27440205 |
| ETIM 7.0 | EC000438 |
| ETIM 6.0 | EC000438 |
| ETIM 5.0 | EC000438 |
| ETIM 4.0 | EC000438 |
| ETIM 3.0 | EC000438 |

Product compliance

| | |
|------------------------------|-----------|
| ROHS conformity status | Compliant |
| REACH-SVHC conformity status | Compliant |

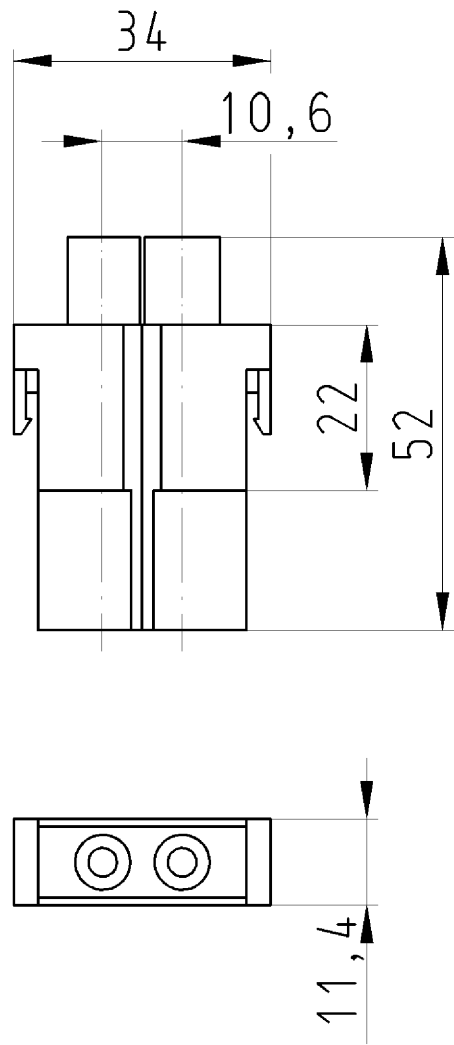

Moduleinsatz
78.003.0253.0

Zeichnungsnummer
78.003.0253.010W
Moduleinsatz

15.11.2007
Hollet Florian
M 1:1