

Female Terminal

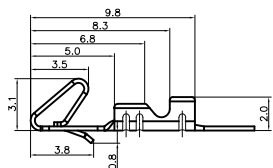

Female Terminal

| Wire Range | | O.D of Wire |
|---------------------------------|-------|-------------|
| Section Area (mm ²) | AWG# | mm |
| 0.2~0.75 | 28~18 | 1.2~2.1 |



Female Housing

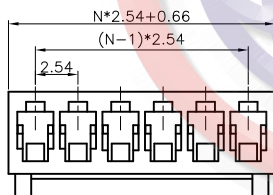
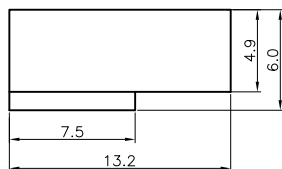

Male Right Angle

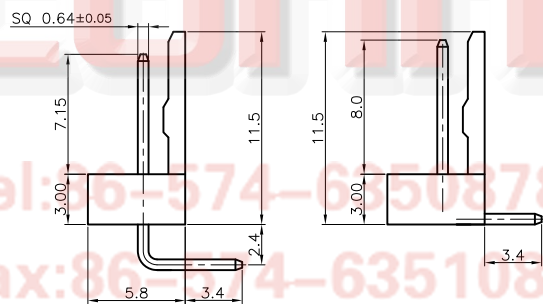
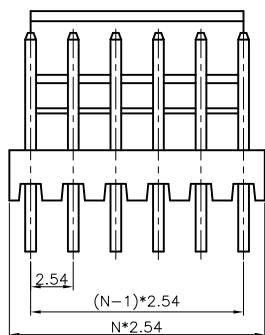

Type A

Type B

Male V/T TYPE

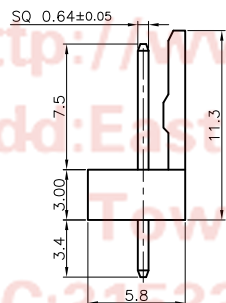
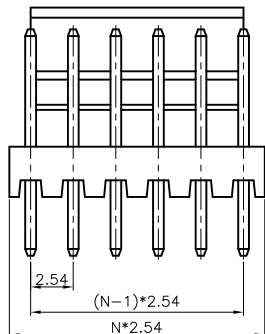

N=NO. OF CONTACTS

| REV. | DESCRIPTION | DRAWN | CHECKED | APPROVED |
|------|-------------|---------------|---------|----------|
| A | NEW RELEASE | YCH 06/27/08' | ~ | |
| | | | | |
| | | | | |

NOTES:

1. MAIN SPECIFICATIONS

- . Housing material: NYLON 66
- . Contact material: Copper alloy
- . Wires range: AWG#28~#18
- . Rated voltage: 250V
- . Rated current: 3A
- . Contact resistance: ≤ 30mΩ
- . Insulation resistance: ≥ 1000MΩ
- . Withstanding voltage: 500V,AC 1 minute
- . Temperature range: -25 ~ +85°C

2. PRODUCT NUMBER CODE:

DS1070 - X X X X X X

Bend Type(R/A Only)

A: Type A
B: Type B

Contact Plating
6: Tin

Housing Color
V: Ivory
T: Transparent
W: White

Mounting type
C: Crimp
R: Right Angle
V: V/T type

Connector type
M: Male
F: Female

No.of contact
2 to 20

Tel: 86-574-63508787
Fax: 86-574-63510817
E-mail: sale@connfly.com
http://www.connfly.com
Add: East Industry Zone KuangYan
Town Cixi Ningbo China
P.C: 315333

| GENERAL TOLERANCE | | ANGLE TOLERANCE | |
|-------------------|-------|-----------------|-----|
| X. | ±0.60 | X. | ±5° |
| .X | ±0.38 | .X | ±3° |
| .XX | ±0.25 | .XX | ±2° |

| PROJECTION | TITLE |
|------------|------------------------------|
| UNITS | P.C.B CONNECTOR Pitch 2.54mm |
| SHEET SIZE | SERIES DS1070 |

| DRAWING TYPE | CUSTOMER | | |
|--------------|-----------------|-------|--------|
| SCALE | 1:1 | SHEET | 1 OF 1 |
| DRAWING NO. | C-DS1070-XXXXXX | | |



晨翔电子有限公司

CONNFLY CONNFLY ELECTRONIC CO., LTD