

## Data sheet

Commercial Art.No.: 71.353.1035.1

Hood BAS GOT GG 10 M25 A1

Hood revos basic made of aluminum, for single locking lever with threaded hole M25 on the right side, low version, 10-poles



|                    |               |
|--------------------|---------------|
| Commercial Art.No. | 71.353.1035.1 |
| EAN                | 4015573651616 |
| Order Unit         | 1             |

Certificates / Approvals



## Technical data

### General

|  |                     |
|--|---------------------|
| Housing material   | aluminum            |
| Color  | Grey                |
| Surface  | With powder coating |
| Degree of protection (IP)                                  | IP65                |
| UV resistant   | yes                 |
| Inflammability class of insulation material acc. with UL94 | Other               |
| Operating temperature range min.                           | -40 °C              |
| Operating temperature range max.                           | 120 °C              |

### Model

|                        |                      |
|------------------------|----------------------|
| Construction           | 10                   |
| Locking mechanism      | Single locking lever |
| Cable entry            | Sideways             |
| Type of cable          | Thread               |
| With cable screw gland | No                   |
| Thread size M          | 25                   |
| Thread size PG         |                      |
| Hinged lid             | No                   |
| EMC-version            | No                   |
| Length                 | 89 mm                |
| Width                  | 43 mm                |
| Height                 | 53 mm                |

### Classification

|            |          |
|------------|----------|
| ECLASS 11  |          |
| ECLASS 8.1 | 27440202 |
| ETIM 7.0   | EC000437 |
| ETIM 6.0   | EC000437 |
| ETIM 5.0   | EC000437 |
| ETIM 4.0   | EC000437 |
| ETIM 3.0   | EC000437 |

#### Product compliance

|                              |                    |
|------------------------------|--------------------|
| ROHS conformity status       | Compliant/Exempted |
| ROHS exceptions              | III-6(a)           |
| REACH-SVHC conformity status | Duty-To-Declare    |
| REACH-SVHC substances        | Lead               |
| REACH-SVHC CAS numbers       | 7439-92-1          |

#### Fits with

| Commercial Art.No.: | Article-type description:          | Description:   |
|---------------------|------------------------------------|--|
| 70.300.1040.0       | Female insert BAS BUS 10 2,5 50    | Female insert revos basic, 10-poles, rated current: 16A, rated voltage:500V, with tin-plated contacts  |
| 70.301.1040.0       | Female insert BAS BUS 10 2,5 50 AU | Female insert revos basic, 10-poles, rated current: 16A, rated voltage:500V, with gold-plated contacts   |
| 70.302.1040.0       | Female insert BAS BUS OD 10 2,5 50 | Female insert revos basic, 10-poles, rated current: 16A, rated voltage:500V, with tin-plated contacts  |
| 70.310.1040.0       | Male insert BAS STS 10 2,5 50      | Male insert revos basic, 10-poles, rated current: 16A, rated voltage: 500V, with tin-plated contacts   |
| 70.311.1040.0       | Male insert BAS STS 10 2,5 50 AU   | Male insert revos basic, 10-poles, rated current: 16A, rated voltage: 500V, with gold-plated contacts  |
| 70.312.1040.0       | Male insert BAS STS OD 10 2,5 50   | Male insert revos basic, 10-poles, rated current: 16A, rated voltage: 500V, with tin-plated contacts   |
| 70.500.1053.0       | Female insert BAS BUF 10 2,5 50    | Female insert revos basic, 10-poles, rated current: 16A, rated voltage:500V, with silver-plated contacts                                       |
| 70.510.1053.0       | Male insert BAS STF 10 2,5 50      | Male insert revos basic, 10-poles, rated current: 16A, rated voltage: 500V, with tin-plated contacts   |
| 70.700.1058.0       | Female insert BAS BUC 10 50        | Female insert revos basic, 10-poles, rated current: 16A, rated voltage:500V, with tin-plated contacts  |
| 70.710.1058.0       | Male insert BAS STC 10 50          | Male insert revos basic, 10-poles, rated current: 16A, rated voltage: 500V, with tin-plated contacts   |
| 70.800.1856.0       | Female insert BAS BUCK 18 50 PC    | Female insert revos basic, 18-poles, polycarbonate insert, rated current: 16A, rated voltage: 500V, with gold-plated or silver-plated contacts |
| 70.810.1856.0       | Male insert BAS STCK 18 50 PC      | Male insert revos basic, 18-poles, polycarbonate insert, rated current: 16A, rated voltage: 500V, with gold-plated or silver-plated contacts   |
| 70.400.0340.0       | Female insert BAS BUS 3 2,5 64     | Female insert revos basic, 3-poles, rated current: 16A, rated voltage: 690V, with tin-plated contacts  |
| 70.410.0340.0       | Male insert BAS STS 3 2,5 64       | Male insert revos basic, 3-poles, rated current: 16A, rated voltage: 690V, with tin-plated contacts  |
| 72.300.1053.0       | Female insert BAS BUS 10 2,5 69    | Female insert revos basic, 10-poles, rated current: 16A, rated voltage:690V, with tin-plated contacts  |
| 72.310.1053.0       | Male insert BAS STS 10 2,5 69      | Male insert revos basic, 10-poles, rated current: 16A, rated voltage: 690V, with tin-plated contacts   |

|               |                                    |  |
|---------------|------------------------------------|--|
| 72.700.1058.0 | Female insert BAS BUC 10 69        | Female insert revos basic, 10-poles, rated current: 16A, rated voltage:690V, with tin-plated contacts    |
| 72.710.1058.0 | Male insert BAS STC 10 69          | Male insert revos basic, 10-poles, rated current: 16A, rated voltage: 690V, with tin-plated contacts     |
| 70.506.0353.0 | Female insert BAS BUF 3 2,5 83 AG  | Female insert revos basic, 3-poles, rated current: 16A, rated voltage: 830V, with silver-plated contacts |
| 70.516.0353.0 | Male insert BAS STF 3 2,5 83 AG    | Male insert revos basic, 3-poles, rated current: 16A, rated voltage: 830V, with silver-plated contacts   |
| 73.800.4253.0 | Female insert DD BUC 42 1,5 25     | revos DD 42 pole + ground, female insert 250V/10A, crimp connection                                      |
| 73.810.4253.0 | Male insert DD STC 42 1,5 25       | revos DD 42 pole + ground, male insert 250V/10A, crimp connection  |
| 70.405.1053.0 | Female insert BAS BUP 10 2,5 50 AG | Female insert revos basic, 10-poles, rated current: 16A, rated voltage:500V, with silver-plated contacts |
| 70.415.1053.0 | Male insert BAS STP 10 2,5 50 AG   | Male insert revos basic, 10-poles, rated current: 16A, rated voltage: 500V, with silver-plated contacts  |
| 72.703.3253.0 | Female insert POW BUC 8/24 AF      |  |
| 72.713.3253.0 | Male insert POW STC 8/24 AF        |  |

These dimensions will be especially checked at delivery  
 Only inspection dimensions  
 With ±E marked dimensions are only valid for internal use

Diese Maße werden bei Abnahme besonders geprüft  
 Ausschließlich Prüfmaße  
 Mit ±E gekennzeichnete Maße sind nur für interne Zwecke gültig

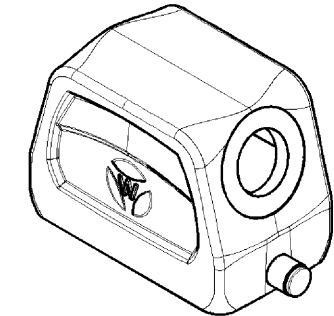
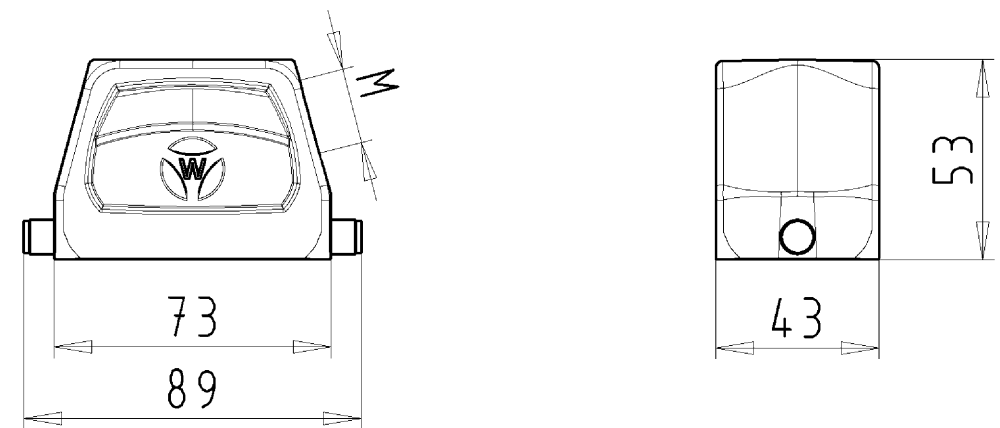

Varianten/ Variants

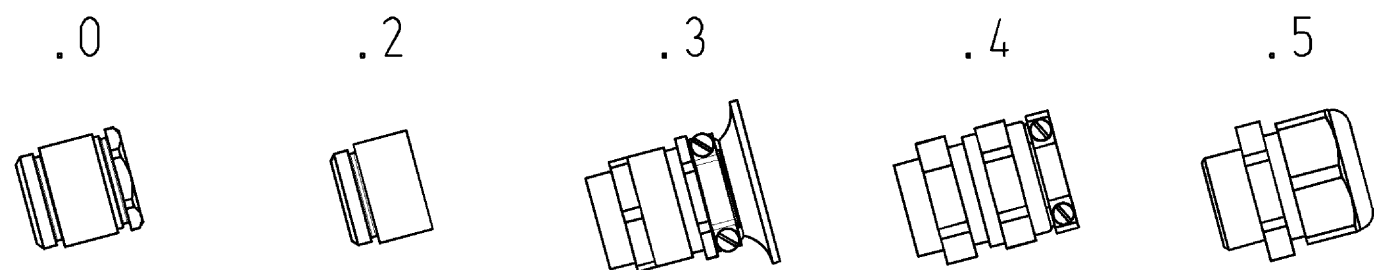

|  |               |            |                        |   |                            |
|--|---------------|------------|------------------------|---|----------------------------|
| 71.35 <sup>3</sup> <sub>0</sub> .1035.5  | BAS GOT GG 10 | M25<br>M20 | A 5                    | Kabelverschraubung(KV), IP65<br>/Cable gland(CG), IP65                                      |                            |
| 71.35 <sup>3</sup> <sub>0</sub> .1035.4  | BAS GOT GG 10 | M25<br>M20 | A 4                    | KV mit Zugentlastung, IP54<br>/CG with strain relief, IP54                                  |                            |
| 71.35 <sup>3</sup> <sub>0</sub> .1035.3  | BAS GOT GG 10 | M25<br>M20 | A 3                    | KV mit Zugentlastung und Knickschutz, IP54<br>/CG with strain relief and bend support, IP54 |                            |
| 71.35 <sup>3</sup> <sub>0</sub> .1035.2  | BAS GOT GG 10 | M25<br>M20 | A 2                    | Zwischenstützen<br>/Bushing   |                            |
| 71.35 <sup>3</sup> <sub>0</sub> .1035.1  | BAS GOT GG 10 | M25<br>M20 | A 1                    | Gewindebohrung<br>/Thread hole  | X                          |
| 71.35 <sup>3</sup> <sub>0</sub> .1035.0  | BAS GOT GG 10 | M25<br>M20 | A 0                    | Kabelverschraubung(KV), IP54<br>/Cable gland(CG), IP54                                      |                            |
| Bestellnummer<br>/Order number   | Typ<br>/Type  |            | Varianten<br>/Variants |   | dar-<br>gestellt<br>/drawn |
| <b>Weitere Daten siehe KATALOG oder eKatalog.<br/>Additional data see CATALOG or eCatalog.</b> |               |            |                        | <b>www.wieland-electric.com<br/>eshop.wieland-electric.com</b>                              |                            |

|   |  |   |  |   |  |   |  |
|---|--|---|--|---|--|---|--|
| Tolerierung Size ISO 14405 <sup>Ⓔ</sup> /Tolerance system Size ISO 14405 <sup>Ⓔ</sup> .<br>(This ISO-standard describes the envelope principle. According to the envelope principle the deviations of form and parallelism are limited by the size tolerances). |  |   |  | ja/yes <input checked="" type="checkbox"/> Stoffverbots- und Deklarationsliste nach UU-TOM-05/03 ist einzuhalten.<br>Conformity with Wieland document UU-TOM-05/03 (list of prohibited / declarable hazardous substances) to be declared! |  |   |  |
| Freitoleranz nach<br>General tolerance  |  | CAD - Zeichnung, keine manuellen Änderungen<br>CAD - drawing, no manual modifications allowed |  | 1.Verwendung:<br>First Use: -   |  | Blatt: 1 von 1<br>Sheet: of 1   |  |
| /   |  | Werkstoff/Material<br>Aluminium<br>beschichtet/ coated<br>grau/ grey                          |  | 2013 Tag/Date<br>Name<br>17.09. Treschan  |  | Zeichnung Nr./Drawing No.<br>Index<br>71.350.1035.0 13K   |  |
| /   |  | Maßstab/Scale<br>1:2  |  | gezeichnet<br>drawn<br>geprüft<br>checked<br>Normgepr.<br>Stand. check  |  | Maße in mm/Dimensions are in mm   |  |
| /   |  | Vol. mm <sup>3</sup> Ofl./Surf. mm <sup>2</sup>   |  | Ersatz für/Replacement for: -   |  |   |  |
| /   |  | wieland<br>Elektrische<br>Verbindungen  |  | Type<br>revos<br>BASIC  |  | Benennung/Titel<br>GEHAEUSEBERTE IL<br>Baugröße 10-Kabelabgang seitlich-M20/M25<br>Hood size 10-cable outlet side-M20/M25 |  |
| Index<br>Datum / Blatt<br>Date / Sheet  |  | Änderung/Revision   |  |   |  |   |  |

Weitergabe sowie Vervielfältigung dieses Dokuments, Verwertung und Mitteilung seines Inhalts sind verboten, soweit nicht ausdrücklich gestattet.  
 The reproduction, distribution and utilization of this document as well as the communication of its contents to others without express authorization is prohibited.

713501035013K\_2 CADW3028 Treschan 2013-09-201093752 1.000