

Rev.	Description	Date
A0	New release	2023.03.24

1. PHYSICAL CHARACTERISTICS (mm)

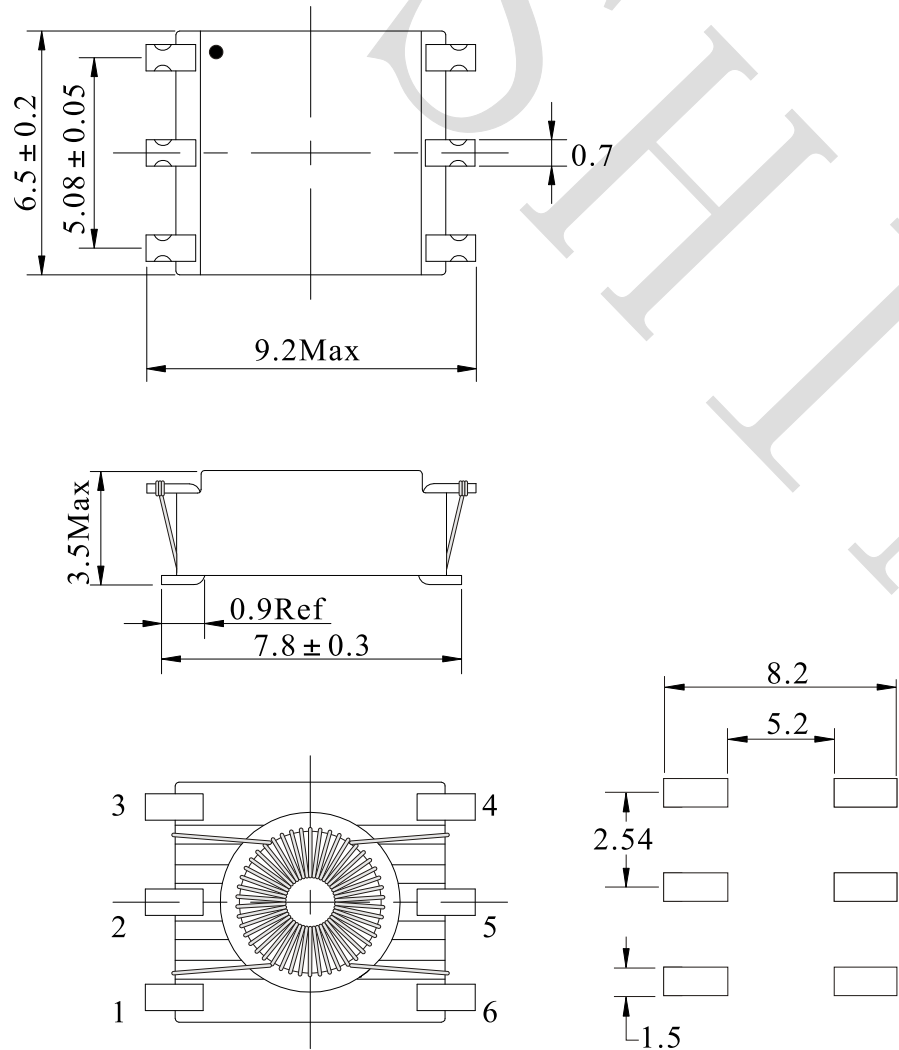

2. ELECTRONICAL SCHEMATIC

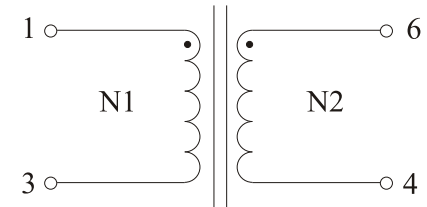

3. ELECTRONICAL SPECIFICATIONS

- Turns ratio: $1:1 \pm 3\%$ @20KHz,0.1V
- Inductance: 785uH Min@100KHz,0.1V
- Lk: 0.46uH Max.@100KHz,0.1V
- DCR: 0.6Ω Max
- ET: 9.7Vusec Max
- Hi-Pot: 1500VDC
- Storage temperature: -40°C to $+125^{\circ}\text{C}$
- Operating temperature: -40°C to $+125^{\circ}\text{C}$

NAME:	Common mode inductor		
CUSTOMER P/N:	PE-68386NL	DATE:	2023-03-24
SHINHOM P/N:	SF0903B-801Y	REV:	A0
DRAWN BY:	CHECKED BY:	APPROVE BY:	