

REV	CONTENT	CHK	DATE
V0.0	CONTENT	ZCL	24.07.18

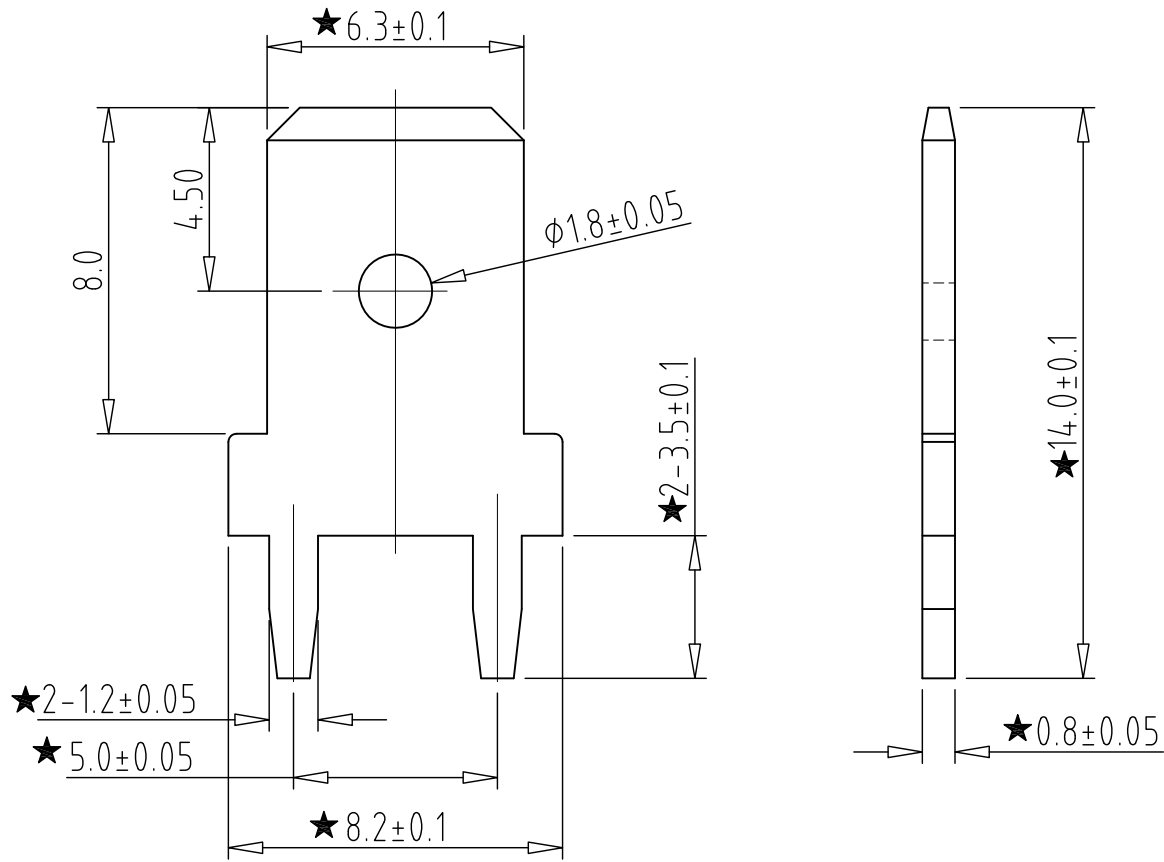

Technical Requirement :

1. No defects such as burrs and deformation on the surface;
2. Material: Copper Alloy;
3. RoHS Compliance;
4. "★" is the key quality control point.

Total Pitch Dimension range in mm						Nominal dimension range in mm						radii		chamfers				∠ short angle sid				≡		—		//							
0 to 6	over 6 to 16	over 16 to 30	over 30 to 120	over 120 to 250	over 250 to 500	0 to 6	over 6 to 10	over 10 to 16	over 16 to 30	over 30 to 53	0.5 to 3	over 3 to 6	over 6 to 30	over 30 to 10	over 10 to 50	over 50 to 120	over 120 to 400	all	0 to 120	over 120 to 200	0 to 120	over 120 to 200	0.1 to 0.2	0.2 to 0.3	0.3 to 0.4	0.4 to 0.5	0.5 to 0.6	0.6 to 0.8	0.8 to 1.0	1.0 to 1.5	1.5 to 2.0	2.0 to 3.0	3.0 to 4.0
±0.07	±0.12	±0.15	±0.2	±0.25	±0.40	±0.09	±0.12	±0.15	±0.17	±0.2	±0.1	±0.2	±0.1	±0.2	±0.5	1'	30'	20'	10'	0.1	0.2	0.3	0.4										

1	Pin	XXXX	1	Copper Alloy	Tin Plated
ITEM	NAME OF PART	NO. OF PART	Q'TY	MATERIAL	NOTE
DWG.	ZCL	DATE	24.07.18	SIZE	A4 UNITS mm SHEET/OF 1/1
CHK.		DATE		SCALE	1:1
APP.		DATE		NAME	T0520 插片端子
宁波冠泰电子有限公司 NINGBO GOLTEN ELECTRONICS CO., LTD.			DWGNO.	XXXX	