

TACT SWITCH SERIES KAN

[SPECIFICATION]

Contact Resistance: $\leq 100\text{m}\Omega$

Insulation Resistance: $\geq 100\text{M}\Omega$

Withstand Voltage : 250V, AC/minute

Temperature Range : $-20^{\circ}\text{C}\sim+70^{\circ}\text{C}$

Rated Load : 12V DC 50mA

Operation Force :

Life : 50000

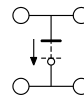
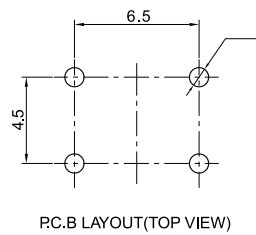
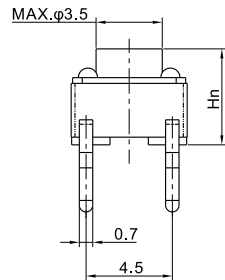
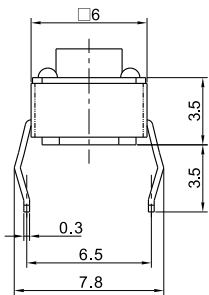

KAN0611-0431B

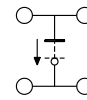
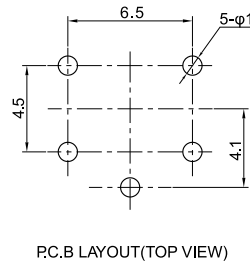
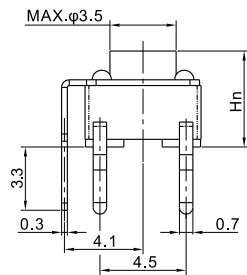
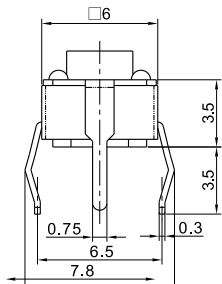

KAN0621-0431B

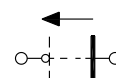
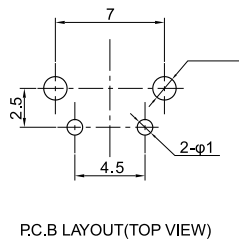
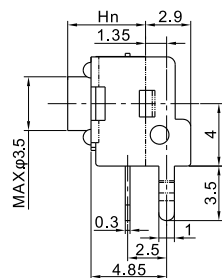
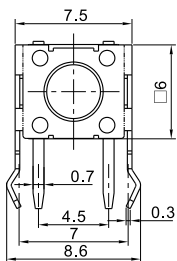

KAN0631-0501B (SWT-7)

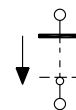
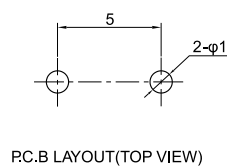
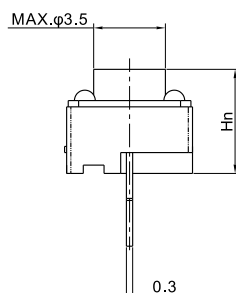
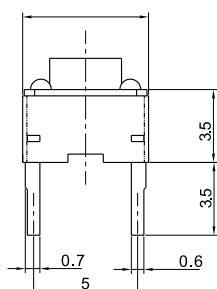

KAN0653-0431B