

Piezo Buzzer



FM-12(24D)-900 Series



FEATURES:

- High output
- Two Voltage ranges available
- Continuous and pulsing tones

DIMENSIONS: (Unit: mm)

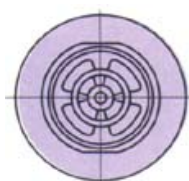

WIRE(L) TYPE

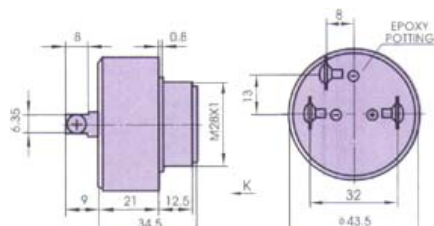
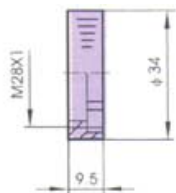

PIN(P) TYPE

CHARACTERISTICS:

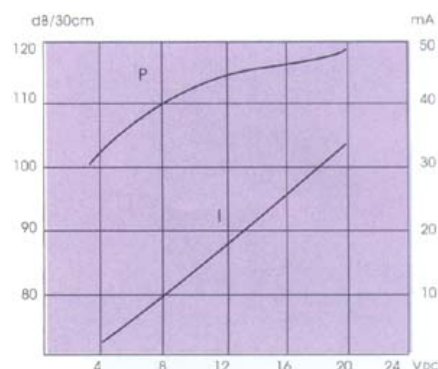

ELECTRICAL SPECIFICATIONS :

Model No .	FM-12(24)D-900	FM-12(24)D-901	FM-12(24)D-903	FM-12(24)D-905	FM-12(24)D-907
Min. Sound Pressure Level (dB)	100(85) /12(24) V _{DC} / 30cm	95(80) /12(24)V _{DC} /30cm			
Rated Voltage (V _{DC})	12(24)				
Operating Voltage (V _{DC})	3 ~ 20 (4 ~ 28)				
Max. Consumption (mA)	20(22) /16(28)V _{DC}				
Oscillating Frequency (kHz)	3.2 ± 0.5 For FM-12D-900 2.9 ± 0.5 For All Other Serial Models				
Tone Nature	Continuous	Fast Pulse	Slow Pulse	Continuous+ Fast pulse	Continuous+ Slow pulse
Operating Temperature (°C)	-20 ~ +70				
Weight (g)	35				
Case Material/Colour	ABS/Black				

PACKING INFORMATION :

Packing :	200 pcs per export carton
Carton Size :	47 X 30.5 X 31 cm
G. Weight :	10.5 kgs
N. Weight :	7 kgs