

Data sheet

Commercial Art.No.: 99.437.5802.2

Connector GST18I3S S1NZR2A MGR01

Connector GST18I3, 3 pole, male, screw connection, high version, 250V/16A, color of coding: pebble gray, color of housing: black



| | |
|--------------------|---------------|
| Commercial Art.No. | 99.437.5802.2 |
| EAN | 4015573646452 |
| Order Unit | 1 |

Technical data

General

| | |
|--|----------------------------------|
| Rated current | 20 A |
| Rated voltage | 250 V |
| Rated impulse voltage | 4 kV |
| strain relief | yes |
| Pollution degree | 2 |
| Mechanical coding | Code 2 |
| Lockable | self-locking (unlocking by tool) |
| Color of coding/ contact carrier | pebble grey |
| Marking of poles | L, N, PE |
| Color of housing inclusive strain relief | black |

Connection Data

| | |
|---|---------------------|
| Cable diameter max. | 11.3 mm |
| Cable diameter min. | 8.3 mm |
| Connection cross section solid mm ² max. | 2.5 mm ² |
| Connection cross section solid mm ² min. | 0.5 mm ² |
| Connection cross section fine stranded mm ² max. | 2.5 mm ² |
| Connection cross section fine stranded mm ² min. | 0.5 mm ² |
| Terminations per pole | 1 |
| sheath strip length | 35 mm |
| Wire strip length | 7 mm |

Model

| | |
|---------------------------|------------------|
| Model | male |
| Connection type | screw connection |
| Degree of protection (IP) | IP20 |

Material

| | |
|--|-----------|
| Housing material | Polyamide |
| halogen free | yes |
| Contact material | CuZn |
| Fire load | 0.114 kWh |
| Insulation components continuous temperature | 100 °C |

| | |
|----------------|------------|
| Surface finish | Tin-plated |
|----------------|------------|

Dimensions

| | |
|--------|---------|
| Length | 54.7 mm |
| Width | 28.2 mm |
| Height | 25.2 mm |

Classification

| | |
|------------|----------|
| ECLASS 11 | |
| ECLASS 8.1 | 27440605 |
| ETIM 7.0 | EC002560 |
| ETIM 6.0 | EC002560 |
| ETIM 5.0 | EC002560 |
| ETIM 4.0 | EC002560 |

Product compliance

| | |
|------------------------------|--------------------|
| ROHS conformity status | Compliant/Exempted |
| ROHS exceptions | III-6(c) |
| REACH-SVHC conformity status | Duty-To-Declare |
| REACH-SVHC substances | Lead |
| REACH-SVHC CAS numbers | 7439-92-1 |

Accessories

| Commercial Art.No.: | Article-type description: | Description: |
|---------------------|-----------------------------------|---|
| 05.587.3156.0 | Lock (G)ST18 WS | Locking device for cable to cable connection GST18i3-5, white |
| 06.561.7853.0 | mounting frame GST18i3 SW | Mounting frame to snap in GST18i3 connectors into a housing or furniture. Wall thickness: 1,5-2,5 mm. Holds GST18i3 connectors with screw or spring connection and pre- assembled cables. |
| 05.561.3653.0 | cover cap GST18i3VS B WS | Cover piece for female GST18i3, white |
| 05.561.3653.1 | cover cap GST18i3VS B SW | Cover piece for female GST18i3, black |
| 05.564.5353.0 | cover cap GST18i3/4/5 SW | Cover piece 12 pole black for female parts GST18i3-6 |
| 05.564.5353.2 | cover cap GST18i3/4/5 WS | Cover piece 12 pole white for female parts GST18i3-6 |
| 05.594.4250.0 | cover cap ST18/3B + GST18i3 ST WS | |
| 05.594.4253.0 | cover cap ST18/3B + GST18i3 ST WS | |
| 05.587.3156.1 | Lock (G)ST18 SW | Locking device for cable to cable connection GST18i3-5, black |

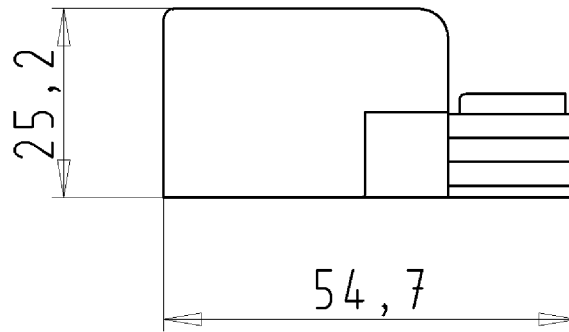
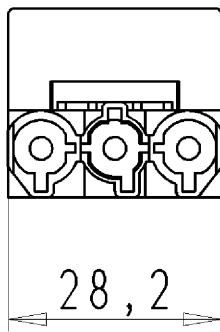

STECKERTEIL
99.437.5802.2 10W
27.06.2008 Lunz S.
M 1:1