

| REVISION RECORD | | | |
|-----------------|-----|-------------|------|
| REV | ECN | DESCRIPTION | DATE |
| | | | |
| | | | |

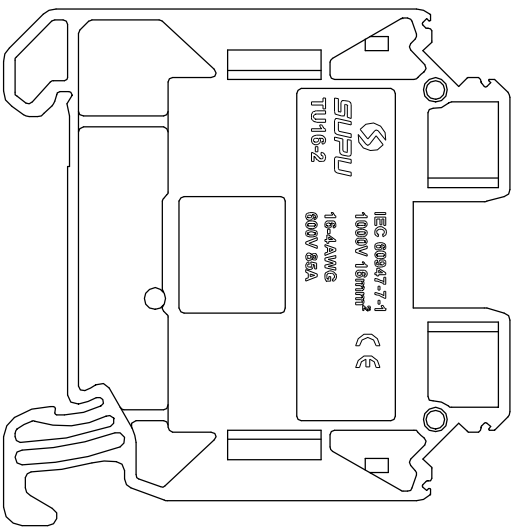
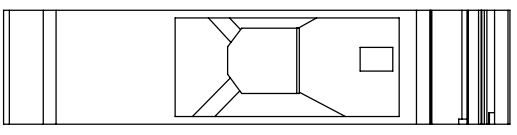
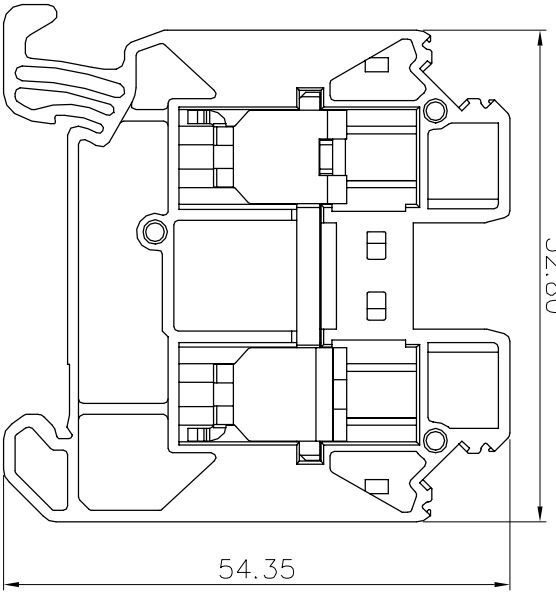
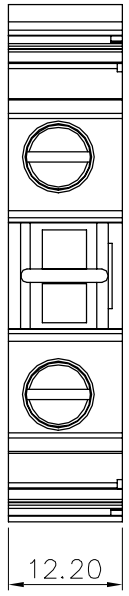

Connection method:
 1.For solid wire, peeling wire in right length, fix in by rated torque force.
 2.For stranded wire,connect directly after peeling in right length,or furruled on wire and fix in by rated torque force.
 (Attention: torque force should be equable, no explosive power.)

Transmittal, reproduction, dissemination and/or editing of this document as well as utilization of its contents and communication thereof to others without express authorization are prohibited.

未经允许禁止传输、复制、编辑该文档，以及利用其内容进行交流

NOTES:
 UL/CUL Standard
 1.Conductor cross section : 16~4AWG
 2.Rated torque : M5 , 21lb.in
 3.Rated Voltage/Current :

| Use group | B | C | D |
|------------------|-----|-----|---|
| Rated voltage(V) | 600 | 600 | |
| Rated current(A) | 85 | 85 | |

IEC Standard
 1. Conductor cross section :

| | |
|---|-----------------------|
| Wire range(Solid/Stranded) | 1.5-16mm ² |
| Solid | 1.5-25mm ² |
| Stranded | 1.5-16mm ² |
| Stranded with ferrules without plastic sleeve | 1.5-16mm ² |
| Stranded with ferrules with plastic sleeve | 1.5-16mm ² |

2.Rated torque : M5 , 2.4N•m
 3.Rated Voltage/Current :

| Surge voltage category | III |
|-------------------------|------|
| Pollution degree | 3 |
| Rated surge voltage(kV) | 8 |
| Rated voltage(V) | 1000 |
| Rated current(A) | 76 |

Material:

| | | |
|-----------|--------------|-----------|
| Insulator | PA66 | UL94 V-0 |
| Cage | Steel | Zn plated |
| Conductor | Copper alloy | Sn plated |
| Screw | Steel | Zn plated |

General information:
 1.Dimension shall be interpreted per ASME Y14.5-2009
 2.Stripping length : 14mm
 3.Operating temperature: -40°C~+105°C
 4.RoHS Compliance
 5.Undimensioned Tolerances:

| Pitch | Over | Over | Over | Over | Over | Over | Over | Over | Over |
|-------|-------|-------|-------|-------|-------|-------|-------|------|------|
| mm | 6 | 10 | 10 | 10 | 10 | 15 | 15 | 15 | 15 |
| ±0.15 | ±0.20 | ±0.30 | ±0.30 | ±0.50 | ±0.70 | ±1.00 | ±1.30 | ±2 | ±2 |

HOW TO ORDER:
 TU16-2-XX

Sereies No.
 Color:
 GY: Grey
 BU: Blue
 OG: Orange

| | | | | | |
|-----------------|---------------|------------------|--|-------------------------|---------------|
| 订货号 Order No | TU16-2-XX | 名称 Name | TU系列16mm ² 螺 钉一进一出接线 端子 | 未注公差 Tolerance | 表面 Surface |
| 项目 Item | 设计 Design | 图号 Drawing No | PRM(O) | 公差表 Tolerances Table | VDI21 |
| 设计 Design | 审核 Check | 材料 Material | Notes | 版本号 Revision Number | 重量 Weight |
| 工艺 Process | 工艺 Check | 物料号 Item No | 411036025 | M0 | 比例 Scale |
| 标准化 Unity | 批准 Approve | 物料号 Item No | 411036026 | 第1页/共1页 1 of 1 | 1:1 |
| 批准 Approve | 日期 Date | 物料号 Item No | 411036027 | | |
| 1w1 | 2020.08.05 | | | | |

NINGBO SUPU ELECTRONICS CO.,LTD.