

REV	CONTENT	CHK	DATE
V0.0	CONTENT	EXL	20.05.11

Electrical :

- | | | |
|---|---|------------------------|
| | UL | IEC |
| 1. Rated Voltage : | 300V | 250V |
| 2. Rated Current : | 10A | 10A |
| 3. Wire Range: | 22-14AWG | 0.2-1.5mm ² |
| 4. Stripping Length : | 9-10mm | |
| 5. Withstanding Voltage : | AC 2000V/1Min. | |
| 6. Operating Temperature : | -40 °C~+105 °C | |
| 7. RoHS Compliance | | |
| 8. Safty Approval : |  | |
| 9. "★" is the key quality control point | | |

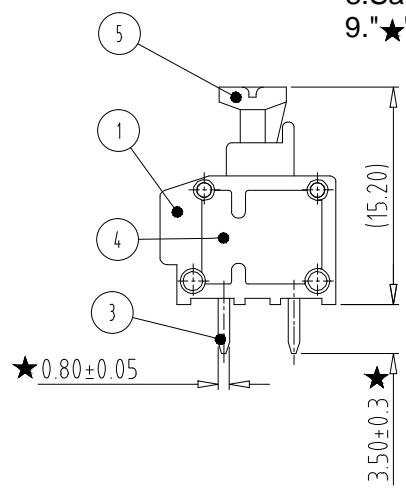
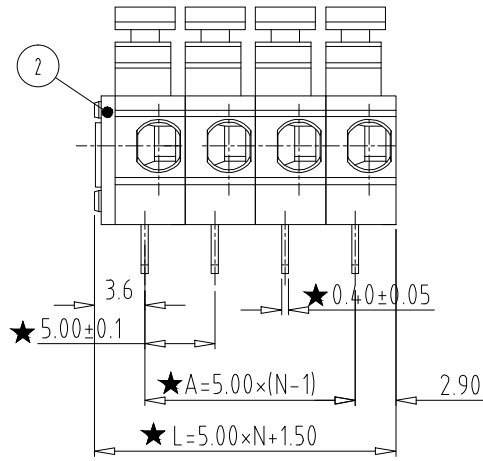
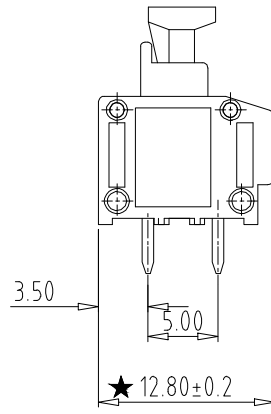
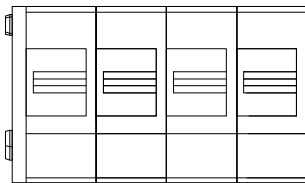
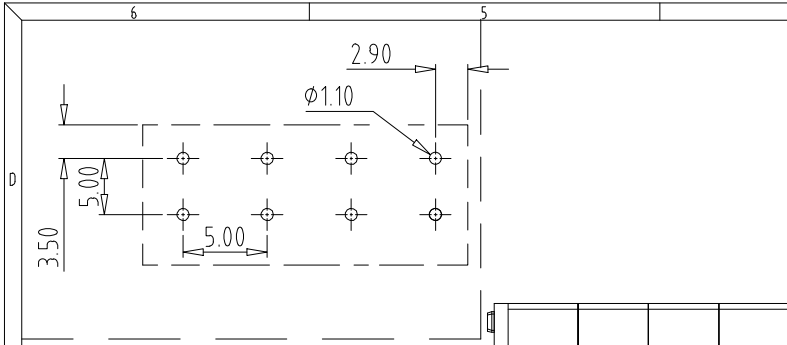

- GT235 - 5.0 -XXP - X X - 00
- | | | | | | |
|------------------------------------|-------|--|---|------------------|---|
| ① | ② | ③ | ④ | ⑤ | ⑥ |
| Series NO. | Pitch | Poles | Color: | Customer Request | |
| ④ 1 Single Pitch
2 Double Pitch | | 02 02Contacts
03 03Contacts
...
24 24Contacts | 1 Grey
2 Blue
3 Black
4 Green
5 Orange
6 Red
7 Transparent
8 Yellow
9 White | 00--Standard | |

5	BUTTON	XX	P	PA66 UL94V-0	SEE NOTE
4	SHRAPNEL	XX	P	Stainless steel	/
3	PIN	XX	P	COPPER ALLOY	Tin Plated
2	COVER	XX	1	PA66 UL94V-0	SEE NOTE
1	HOUSING	XX	P	PA66 UL94V-0	SEE NOTE

Total Pitch Tolerances in mm										Nominal dimension range in mm														
over	over	over	over	over	over	over	over	over	over	over	over	over	over	over	over	over	over	over	over	=	//	over	over	
0	30	53	70	90	115	150	250	350	500	0	30	53	70	90	115	150	200	250	320	0	over	0	100	over
±0.18	±0.20	±0.25	±0.3	±0.35	±0.44	±0.60	±0.70	±0.85	±0.20	±0.25	±0.30	±0.35	±0.44	±0.55	±0.70	±0.80	±0.90	0.2	0.3	0.3	0.3	0.2	0.3	0.5

ITEM	NAME OF PART	NO. OF PART	Q'TY	MATERIAL	NOTE
DWG.	CXL	DATE	20.05.11	SIZE	A4 UNITS mm SHEET/OF 1 / 1
CHK.	DATE			SCALE	1:1
APP.	DATE			NAME	GT235-5.0-XXP-XX-00
				DWGNO.	XXXX

Golten 宁波冠泰电子有限公司
NINGBO GOLTEN ELECTRONICS CO., LTD.