

## Data sheet

Commercial Art.No.: 99.508.0028.0

distributor box GST18 LEER + VERRIEGELUNG

gehis® distribution box empty incl. 4 locking clips; capable for the installation of GST18 device connectors; up to 7 poles each on two sides; box can be combined to a stack; fits to supporting plate 07.413.6853.1.

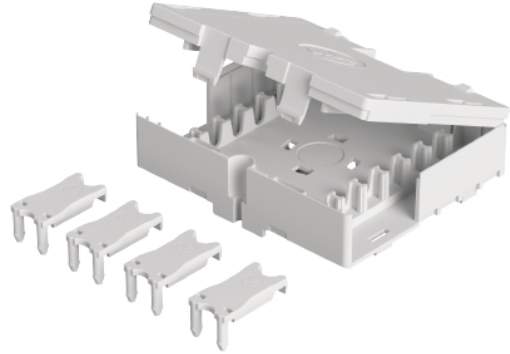

Commercial Art.No.	99.508.0028.0
EAN	4049088310478
Order Unit	50

## Technical data

### Classification

ECLASS 8.1	27440603
ETIM 7.0	EC002560
ETIM 6.0	EC002567
ETIM 5.0	EC002567
ETIM 4.0	EC002567

### Technical data

Length	126 mm
Width	73 mm
Height	25.6 mm
Color	Grey
Description 1	distributor box GST18®, left empty for device connections, max. 7 poles per side
Description 2	with fastening option to 07.413.6853.1/0

### Product compliance

REACH-SVHC conformity status	Compliant
------------------------------	-----------

## Accessories

Commercial Art.No.:	Article-type description:	Description:
07.413.6853.1	Supporting plate GST18 VERTEILER SW	gehis®-Mounting plate for GST18-distributors. Wall mounting with screws or gas-actuated nailers; fixing on cable trays with moulded expanding rivets; lying distributor mounting

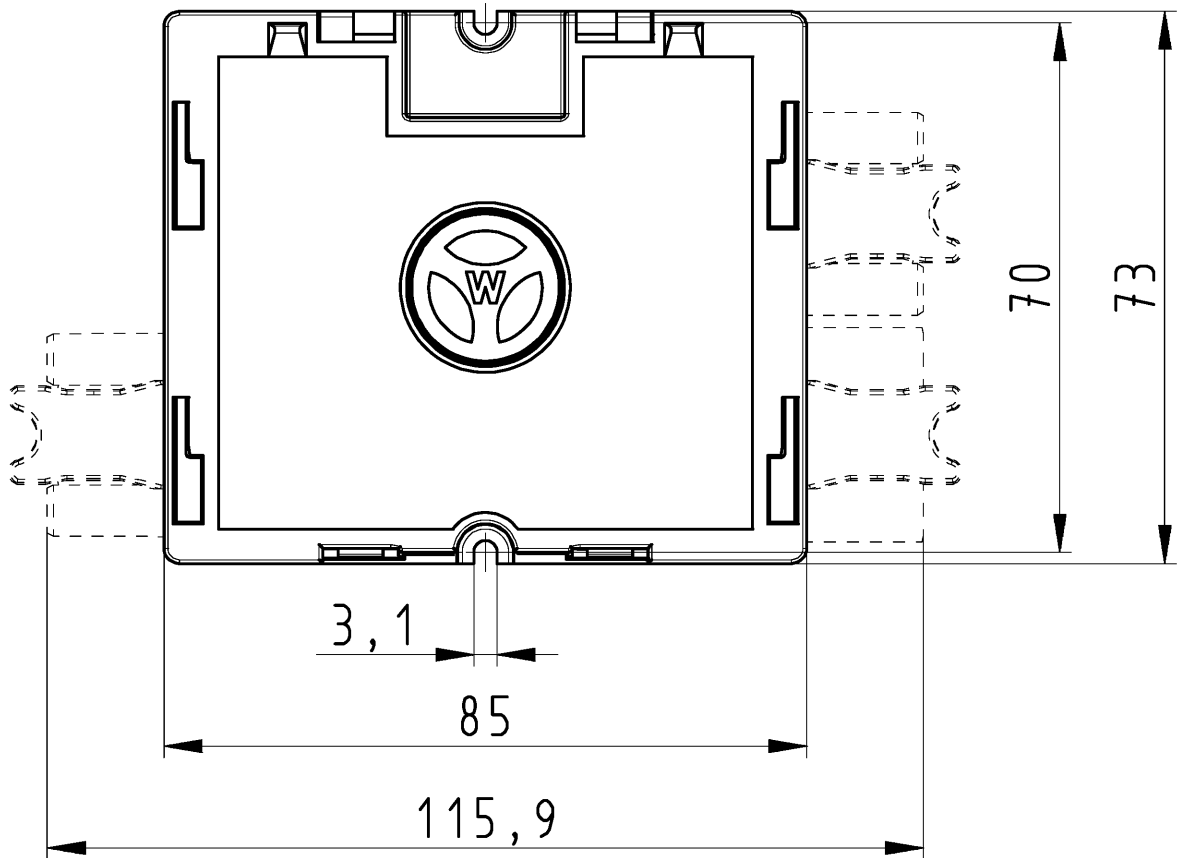
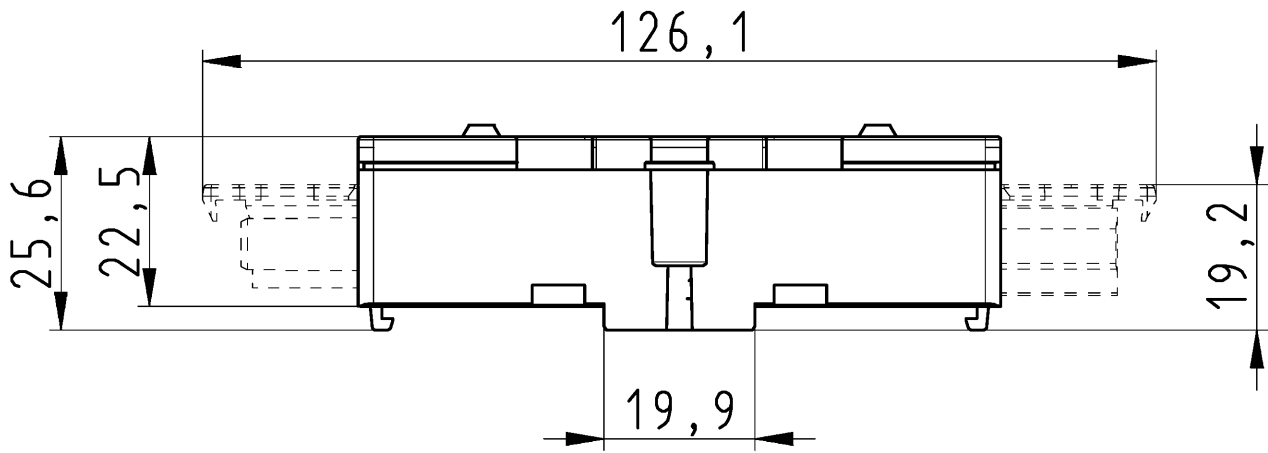

Weitergabe sowie Vervielfältigung dieses Dokuments, Verwertung und Mitteilung seines Inhalts sind verboten, soweit nicht ausdrücklich gestattet. Die Reproduktion, Distribution und Utilization of this document as well as the communication of its contents to others without express authorization is prohibited.

VERTEILERBOX LEERBOX  
 99.508.0028.0 10W  
 M1:1  
 25.11.15