

SALES PROGRAM AND TECHNICAL HANDBOOK



Primary Lithium Cells
Li-MnO₂

CONTENT

| | | |
|-----|---|-------|
| 1. | GENERAL INFORMATION | 3–8 |
| 1.1 | Constructions of Lithium Cells | 4–5 |
| 1.2 | Characteristics and Applications | 6 |
| 1.3 | Applications for Primary Lithium Cells | 7 |
| 1.4 | Selection Guide | 8 |
| 2. | CR PRIMARY LITHIUM BUTTON CELLS | 9–18 |
| 2.1 | Types – Technical Data | 10 |
| 2.2 | Assemblies | 11–13 |
| 2.3 | Performance Data | 14–18 |
| 3. | CR HIGH CAPACITY PRIMARY LITHIUM CYLINDRICAL CELLS | 19–24 |
| 3.1 | Types – Technical Data | 20 |
| 3.2 | Assemblies | 21 |
| 3.3 | Performance Data | 22–24 |
| 4. | CR HIGH POWER PRIMARY LITHIUM CYLINDRICAL CELLS | 25–30 |
| 4.1 | Types – Technical Data | 26 |
| 4.2 | Assemblies | 26 |
| 4.3 | Performance Data | 27–30 |
| 5. | GENERAL DESIGN CHARACTERISTICS | 31–37 |
| 5.1 | Safety Tests | 33 |
| 5.2 | Safety Guidelines | 34–35 |
| 5.3 | Transportation of VARTA Microbattery Lithium Cells and Batteries | 36 |
| 5.4 | Application Check List | 37 |

Subject to change without further notice. Errors excepted. For latest technical data please refer to our data sheets which you will find on our website www.varta-microbattery.com.

1. GENERAL INFORMATION

The VARTA Microbattery lithium manganese dioxide cell chemistry was one of the first solid cathode cells commercially developed and is still the most widely used system today. These cells offer an excellent shelf life, good high-rate and low-rate capability, a wide operating temperature range and availability in button and cylindrical cell designs. Potential design-in

applications for these products are electronic, telecommunication, metering, instrumentation, office and other portable equipment use. Based on the outstanding cell performance and reliability of these products, they have been able to meet and exceed the requirements of our customer base worldwide.

Advantages for VARTA Microbattery Li-MnO₂ Cells

- High open circuit and load voltage (above 3.0 volts per cell)
- High energy density (400 Wh/kg and 600 Wh/l)
- High capacity and high rate cell construction
- Operation over a wide temperature range
- Flat discharge profile under low to medium rate applications
- Low self discharge (less than 1% per year at RT)
- Superior shelf life and operational life (Up to 10 years and more)
- UL Recognition
- Ability to provide a variety of laser welded termination tabs for all cell types

Energy Density for Primary Systems

FIG. 1
Comparison of different primary battery systems

- A = Lithium
- B = Silver-oxide
- C = Alkaline
- D = Zinc-chloride

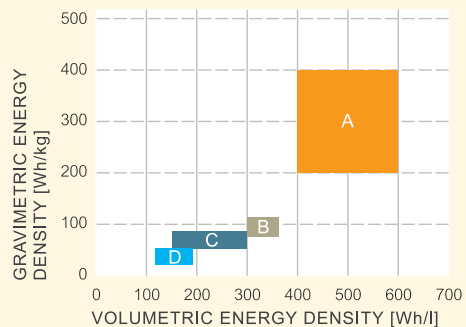

1.1 CONSTRUCTIONS OF LITHIUM CELLS

VARTA Microbattery offers a complete range of primary lithium manganese dioxide cylindrical and button cells for memory backup and portable applications worldwide. The cylindrical cell configurations offer the high-capacity bobbin construction and high-power spirally wound product. The bobbin construction is targeted at low to moderate power requirements, dedicated for applications

requiring up to a 10 years operational life at 20°C. Our spirally wound electrode product offers high-rate discharge capability, with an operational life in excess of 5 years.

For compact and light weight equipment use we have a complete range of high performance primary lithium button cells.

Lithium Cylindrical Batteries

FIG. 2 – BOBBIN CONSTRUCTION

Schematic construction of a Li/MnO₂ cylindrical cell (CR 1/2 AA).

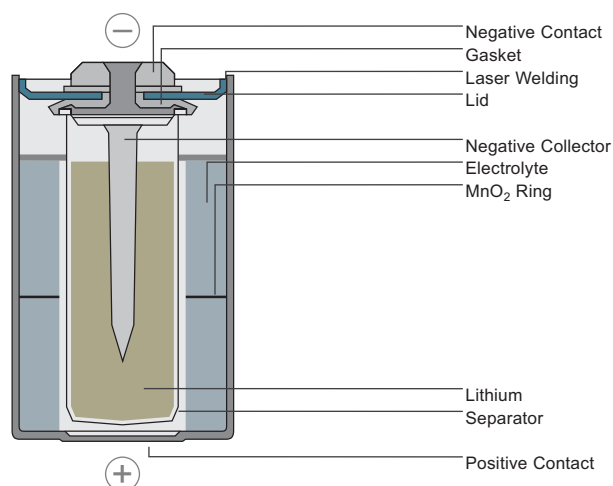
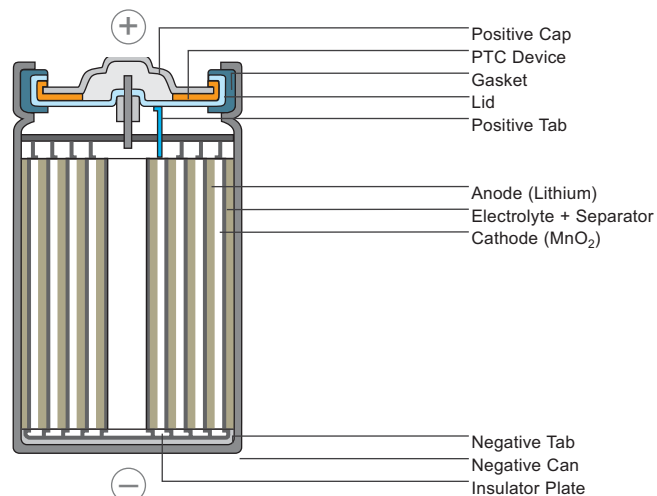

FIG. 3 – SPIRAL CONSTRUCTION

Schematic construction of a Li/MnO₂ cylindrical cell (CR 1/2 AA).



Lithium Button Cells

FIG. 4
Schematic construction of a
Li/MnO₂ Button Cell

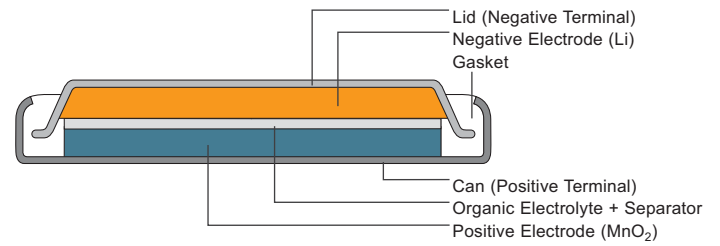

Sealing Technologies

FIG. 5 – CRIMP-SEALING
CR High Power Cylindrical Cells

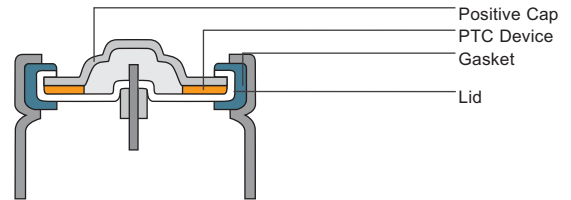
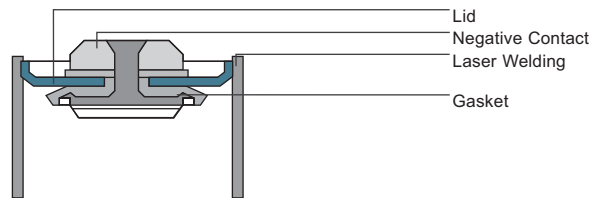

FIG. 6 – LASER-SEALING
CR High Capacity Cylindrical Cells



1.2 CHARACTERISTICS AND APPLICATIONS

Main Applications

Both mechanical and electrical properties, together with reliability, ensure that VARTA Microbattery lithium batteries meet the requirements of modern electronics.

They are therefore ideally suited as power sources for the long term supply of microelectronic circuitry.

Main Characteristics

- Long life expectancy and long operational life
- Low self discharge rate
- High energy density
- High cell voltage (3V)
- Wide temperature range
- High operating safety
- High reliability
- Resistance to corrosion with stainless steel case
- No leakage problems with an organic non-corrosive electrolyte

Temperature characteristics

FIG. 7
Temperature characteristics of CR 1/2 AA and CR AA cylindrical cells
(Load: 5.6 kΩ CR AA, 12 kΩ CR 1/2 AA)

- A = -40°C
- B = +80°C
- C = +60°C
- D = -20°C
- E = +23°C

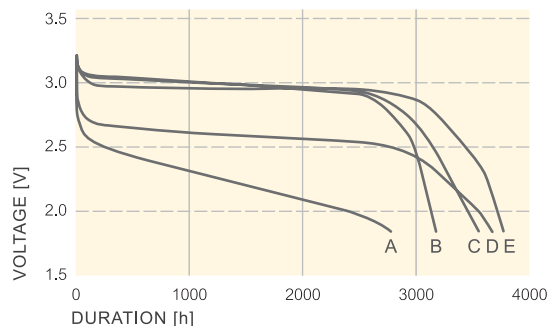

System properties of Varta Microbattery Lithium Cells

| Series | CR Series Cylindrical Cells | CR Series Button Cells |
|--|------------------------------|------------------------------|
| System | Li/MnO ₂ | Li/MnO ₂ |
| Gravimetric energy density | 250–300 Wh/kg | 250–300 Wh/kg |
| Nominal voltage | 3.0 V | 3.0 V |
| Open circuit voltage | 3.2 V | 3.2 V |
| Available capacity range | 950–2000 mAh | 25–560 mAh |
| Storage life | Δ10 years ¹⁾ | Δ5 years ¹⁾ |
| Self discharge d=20 °C | <1% p.a. | <1% p.a. |
| Operating temperature | -30 ... +75 °C ²⁾ | -20 ... +65 °C |
| Maximum temperature range (short term) ³⁾ | -40 ... +80 °C ⁴⁾ | -40 ... +80 °C ⁴⁾ |
| Storage temperature ⁵⁾ | -55 ... +75 °C ²⁾ | -55...+70 °C |

TAB. 1
¹⁾ CR 2/3 AH, CR 2, (>5 years)
²⁾ CR 2/3 AH (-20 ... +65 °C)
³⁾ max. two weeks
⁴⁾ μA-range
⁵⁾ Recommended room temperature

1.3 APPLICATIONS FOR PRIMARY LITHIUM CELLS

| Applications | Button Cells | | Cylindrical Cells (Spirally wound) | | Cylindrical Cells (Bobbin construction) | |
|----------------------------------|-------------------|---------------|------------------------------------|---------------|---|---------------|
| | Main power source | Memory backup | Main power source | Memory backup | Main power source | Memory backup |
| Telecommunications | | | | | | |
| Std. Telephone | | + | | + | | + |
| Cordless Telephone | | + | | + | | + |
| Cellular Telephone | | + | | | | |
| Mobile Radio | | + | | + | | + |
| PABX | | | | + | | + |
| Utility Meters | | | | | | |
| Gas Meter | | | + | | + | |
| Heat Distribution Meter | | | | | + | |
| Electric Meter | | | | | + | |
| Water Meter | | | + | | + | |
| Office Automation | | | | | | |
| Computer | | + | | | | + |
| Copy Machine | | | | + | | + |
| Printer | | + | | | | |
| Fax | | + | | | | |
| Vending Machine | | + | | | | |
| Electronic Typewriter | | + | | | | |
| Process Control Equipment | | | | | | |
| Taxi Meter | | + | | | | |
| Transponder | | | + | | | |
| Intelligent Tagging | + | | | | | |
| Electric Parking Meter | | | + | | + | |
| Data Logger | | | | | | + |
| Dive Computer | | | | | + | |
| Consumer Products | | | | | | |
| Electronic Games | + | | | | | |
| Watch / Clock | + | | + | | | + |
| Calculator | + | | | | | |
| Compass | | | | + | | + |
| Car Radio | | + | | | | |
| Video Recorder | | + | | | | |
| Automotive | | | | | | |
| Car lock system | + | | | | | |
| Dashboard | + | + | | | | |
| Security | | + | | | | |

TAB. 2
Application list

1.4 SELECTION GUIDE

To enable battery selection the following is required:

- discharge current and maximum discharge time
 - capacity
- operating temperature range
 - self discharge
 - surplus capacity requirement
- cell size

FIG. 8
CAPACITY RETENTION
 Capacity retention characteristics of VARTA Microbattery Lithium Cells Cylindrical Cells CR...AA and CR...A

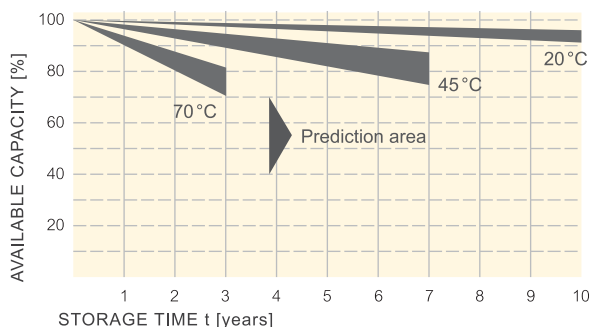

FIG. 9
STORAGE BEHAVIOR
 Typical storage behaviour at room temperature 21°C of CR 1/2 AA

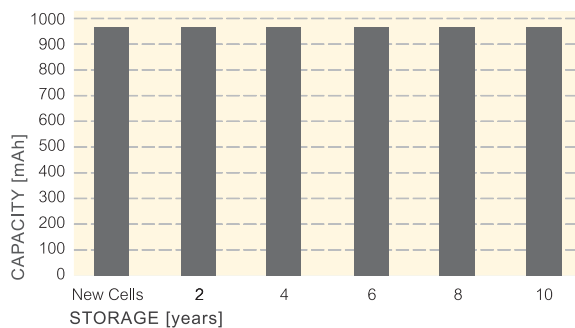
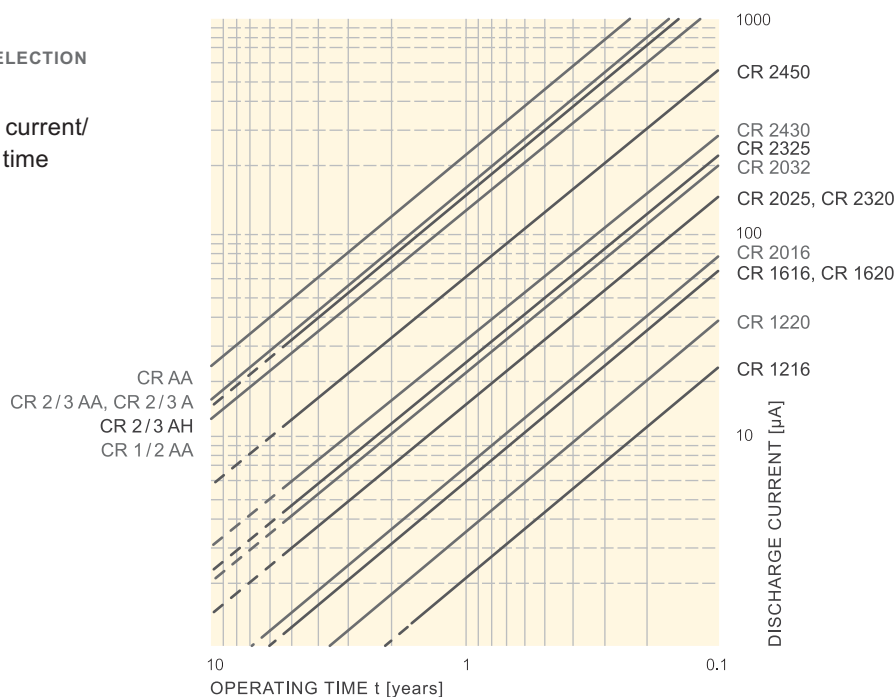

FIG. 10
BATTERY SELECTION DIAGRAMM
 Discharge current/ Operating time



2. CR PRIMARY LITHIUM BUTTON CELLS



2.1 TYPES – TECHNICAL DATA



| Type | Order No. | Nominal voltage (V) | Typical capacity ¹⁾ (mAh) | Standard load (kΩ) | Max. discharge current (continuous) (mA) | Max. discharge current (pulse) (mA) | Weight (g) |
|------------------------|--------------|---------------------|--------------------------------------|--------------------|--|-------------------------------------|------------|
| CR 1/3 N | 6131 101 501 | 3 | 170 | 5.6 | 20 | 80 | 3.0 |
| 2 CR 1/3 N (p.28 p.xl) | 6231 210 501 | 6 | 170 | 13 | 20 | 80 | 8.8 |
| CR 1216 | 6216 101 501 | 3 | 27 | 39 | 2 | 5 | 0.7 |
| CR 1220 | 6220 101 501 | 3 | 35 | 39 | 2 | 5 | 0.8 |
| CR 1616 | 6616 101 501 | 3 | 55 | 39 | 3 | 8 | 1.2 |
| CR 1620 | 6620 101 501 | 3 | 70 | 20 | 3 | 8 | 1.2 |
| CR 2016 | 6016 101 501 | 3 | 90 | 15 | 3 | 10 | 1.8 |
| CR 2025 | 6025 101 501 | 3 | 165 | 10 | 3 | 10 | 2.5 |
| CR 2032 | 6032 101 501 | 3 | 230 | 5.6 | 3 | 10 | 3.0 |
| CR 2430 | 6430 101 501 | 3 | 280 | 5.6 | 3 | 20 | 4.0 |
| CR 2450 | 6450 101 501 | 3 | 560 | 5.6 | 2 | 20 | 6.2 |

TAB. 3

Technical data, CR Primary Lithium Button Cells

¹⁾ Nominal capacity is determined to an end voltage of 2.0 V (type 2 CR 1/3 N: 4.0 V) when the battery is allowed to discharge at standard load level at 20°C

2.2 ASSEMBLIES



CR 1/3 N

| Type | Order No. | A | B | C | D | E | F | G | H | I | K | L | Fig. No. | Remarks |
|--------------------------|--------------|------|------|------|----------|-----------|------------|---|----------|-----|------|-----|----------|---------------------|
| CR 1/3 N | 6131 101 501 | 11.6 | 10.8 | 0.4 | - | 7.8 | - | - | - | - | - | - | 11 | - |
| CR 1/3 N SLF | 6131 201 501 | 13.0 | 1.0 | 10.0 | 1.0 ±0.3 | 11.5 ±0.5 | 12.0 ±0.15 | - | 1.0 ±0.3 | 3.0 | - | - | 14 | tag 0.25 mm |
| CR 1/3 N LF | 6131 301 501 | - | - | - | - | 11.5 | 12.0 | - | - | - | 19.0 | 4.0 | 13 | tag 0.25 mm 180° |
| 2 CR 1/3 N (p 28 pxl) | 6231 210 501 | 13.0 | 25.1 | 1.1 | 0.6 | 5.5 | 6.0 | - | - | - | - | - | 12 | - |
| 3 CR 1/3 N | 6331 101 501 | 12.2 | 32.2 | 0.4 | - | 7.8 | - | - | - | - | - | - | 11 | - |

TAB. 4

Tag material: nickel plated sheet-steel. SLF: tip tinned.

Custom made assemblies are available on request for large volume.

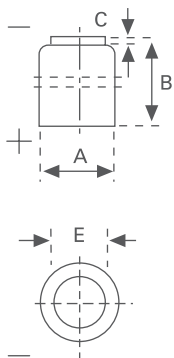

FIG. 11

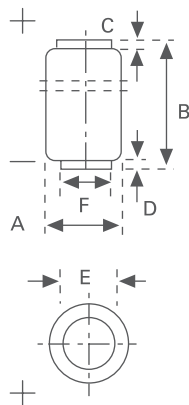

FIG. 12

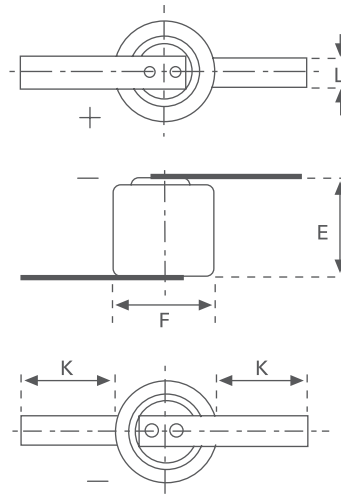

FIG. 13 LF

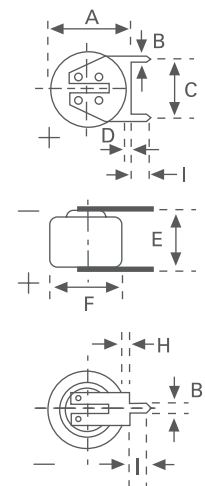

FIG. 14 SLF

| Type | Order No. | A | B | C | D | E | F | G | H | I | K | L | Fig. No. | Remarks |
|-------------|--------------|------|-----|------------|----------|----------|------------|-----|----------|-----|------|-----|----------|-------------|
| CR 1216 | 6216 101 501 | 12.5 | 1.6 | 0.2 | - | 10.0 | - | - | - | - | - | - | 15 | |
| CR 1220 | 6220 101 501 | 12.5 | 2.0 | 0.3 | - | 10.0 | - | - | - | - | - | - | 15 | |
| CR 1616 | 6616 101 501 | 16.0 | 1.6 | 0.2 | - | 12.0 | - | - | - | - | - | - | 15 | |
| CR 1620 | 6620 101 501 | 16.0 | 2.0 | 0.02 | - | 12.9 | - | - | - | - | - | - | 15 | |
| CR 2016 | 6016 101 501 | 20.0 | 1.6 | 0.1 | - | - | - | - | - | - | - | - | 15 | |
| CR 2016 SLF | 6016 201 501 | 21.3 | 1.0 | 10.0 ±0.15 | 1.0 ±0.3 | 2.1 ±0.5 | 20.3 ±0.15 | - | 1.0 ±0.3 | 4.5 | - | - | 16 | tag 0.25 mm |
| CR 2016 LF | 6016 301 501 | 20.0 | - | - | - | 1.9 | 20.0 | - | - | - | 10.0 | 4.0 | 17 | tag 0.15 mm |
| CR 2016 PCB | 6016 401 501 | 20.0 | 1.0 | 10.0 | 9.1 | 1.6 | 17.8 | 7.3 | 10.0 | 4.5 | 11.4 | - | 18 | tag 0.15 mm |
| CR 2016 SMT | 6016 301 012 | 20.5 | 3.5 | 1.8 | 3.0 | 2.2 | - | - | - | - | - | - | | |
| CR 2025 | 6025 101 501 | 20.0 | 2.5 | 0.2 | - | - | - | - | - | - | - | - | 15 | |
| CR 2025 SLF | 6025 201 501 | 21.3 | 1.0 | 10.0 ±0.2 | 1.0 ±0.3 | 3.0 ±0.5 | 20.3 ±0.15 | - | 1.0 ±0.3 | 4.5 | - | - | 16 | tag 0.25 mm |
| CR 2025 LF | 6025 301 501 | 20.0 | - | - | - | 2.8 | 20.3 | - | - | - | 10.0 | 4.0 | 17 | tag 0.15 mm |
| CR 2025 PCB | 6025 401 501 | 20.0 | 1.0 | 10.0 | 10.0 | 2.5 | 17.8 | 7.3 | 10.0 | 4.5 | 11.4 | - | 18 | tag 0.15 mm |

TAB. 5.1
 Tag material: nickel plated sheet-steel. SLF: tip tinned.
 Custom made assemblies are available on request for large volume.

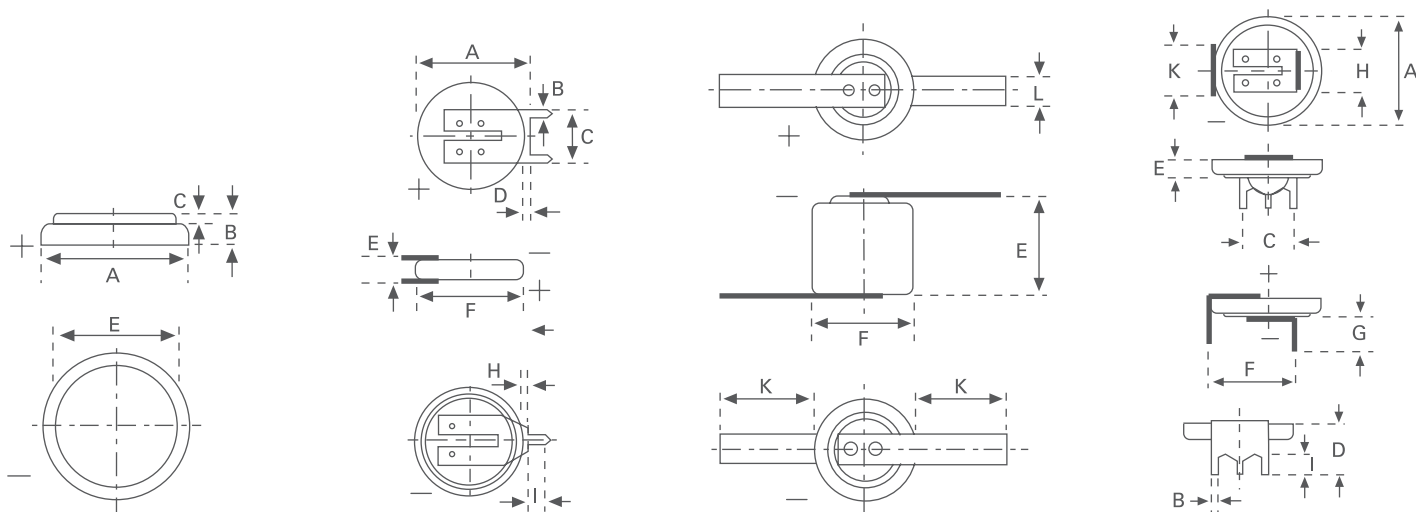

FIG. 15

FIG. 16 SLF

FIG. 17 LF

FIG. 18 PCB 3

| Type | Order No. | A | B | C | D | E | F | G | H | I | K | L | Fig. No. | Remarks |
|--------------------------|--------------|------|-----|------|------|------|------|-----|------|-----|------|-----|----------|---------------------------|
| CR 2032 | 6032 101 501 | 20.0 | 3.2 | 0.02 | - | 16.5 | - | - | - | - | - | - | 15 | - |
| CR 2032 SLF | 6032 201 501 | 21.5 | 1.0 | 10.0 | 1.0 | 4.2 | 20.3 | - | 1.0 | 4.5 | - | - | 16 | tag 0.25 mm |
| CR 2032 LF | 6032 301 501 | - | - | - | - | 3.2 | 20.3 | - | - | - | 10 | 4.0 | 17 | tag 0.15 mm |
| CR 2032 PCB 3 | 6032 401 501 | 20.0 | 1.0 | 10.0 | 11.0 | 3.2 | 17.8 | 7.5 | 10.0 | 4.5 | 11.4 | - | 18 | tag 0.25 mm |
| CR 2032 PCB 2 | 6032 701 501 | 20.0 | 1.0 | - | 11.0 | 3.2 | 17.8 | 7.3 | 10.0 | 4.5 | 10.0 | - | 19 | tag 0.20 mm |
| CR 2032 WC ¹⁾ | 6032 101 013 | 20.7 | - | - | - | 5.5 | 30.0 | - | - | - | 96.0 | 2.0 | 20 | tag 0.20 mm ²⁾ |
| CR 2032 SMT | 6032 301 012 | 20.0 | 7.0 | 2.8 | 5.0 | 3.8 | - | - | - | - | - | - | 21 | - |
| CR 2430 | 6430 101 501 | 24.5 | 3.0 | 0.3 | - | 20.0 | - | - | - | - | - | - | 15 | - |
| CR 2430 SLF | 6430 201 501 | 25.8 | 1.0 | 10.0 | 1.0 | 4.0 | 25.0 | - | 1.0 | 4.5 | - | - | 16 | tag 0.25 mm |
| CR 2430 LF | 6430 301 501 | - | - | - | - | 3.2 | 25.0 | - | - | - | 10.0 | 4.0 | 17 | tag 0.15 mm |
| CR 2430 PCB 3 | 6430 401 501 | 24.5 | 1.0 | 10.0 | 11.0 | 3.0 | 17.8 | 7.5 | 10.0 | 4.5 | 11.4 | - | 18 | tag 0.25 mm |
| CR 2430 PCB 2 | 6430 701 501 | 24.5 | 1.0 | - | 11.0 | 3.0 | 20.0 | 7.5 | 10.0 | 4.5 | 11.4 | - | 19 | tag 0.20 mm |
| CR 2430 SMT | 6430 301 012 | 24.5 | 5.2 | 4.0 | 5.0 | 3.3 | - | - | - | - | - | - | 21 | - |
| CR 2450 | 6450 101 501 | 24.7 | 5.0 | 0.5 | - | 21.8 | - | - | - | - | - | - | 15 | - |
| CR 2450 SLF | 6450 201 501 | 25.8 | 1.0 | 10.0 | 1.0 | 6.0 | 25.0 | - | 1.0 | 4.5 | - | - | 16 | tag 0.25 mm |
| CR 2450 PCB 3 | 6450 401 501 | 24.5 | 1.0 | 10.0 | 13.2 | 5.0 | 17.8 | 7.5 | 10.0 | 4.5 | 11.4 | - | 18 | tag 0.25 mm |
| CR 2450 PCB 2 | 6450 701 501 | 24.7 | 1.0 | - | 12.7 | 5.0 | 17.8 | 7.5 | 10.0 | 4.5 | 11.4 | - | 19 | tag 0.20 mm |
| CR 2450 SMT | 6450 301 012 | 24.5 | 4.5 | 2.8 | 3.5 | 5.3 | - | - | - | - | - | - | 21 | - |

TAB. 5.2

Tag material: nickel plated sheet-steel. SLF: tip tinned.

¹⁾ using Molex 51021-03 connector (Other wire connectors and wire length are available on request.) ²⁾ in shrink sleeve with wire and connector

Custom made assemblies are available on request for large volume.

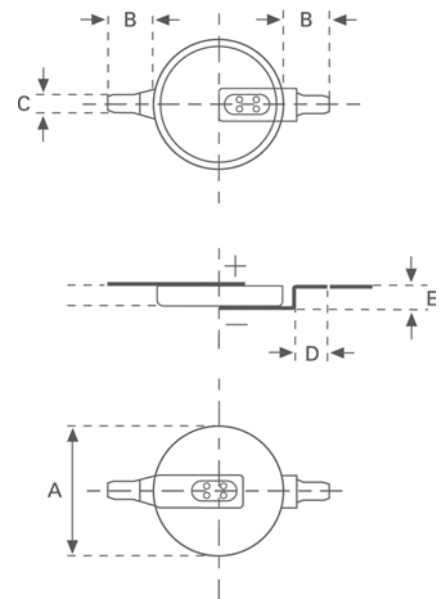
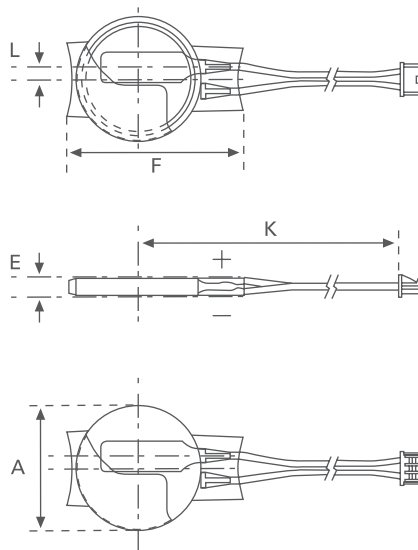
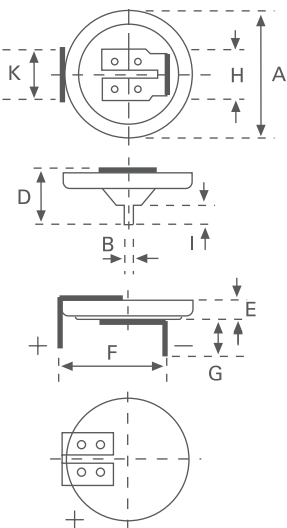

2.3 PERFORMANCE DATA

FIG. 22 – CR 1216
Discharge characteristics
at room temperature (21°C)

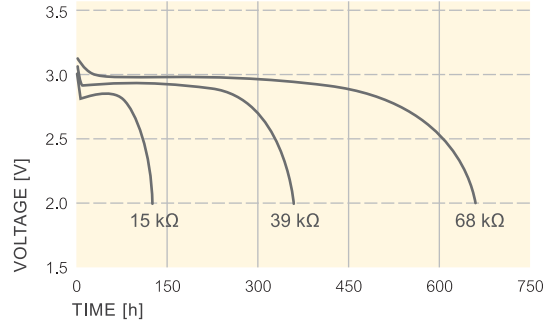

FIG. 23 – CR 1216
Temperature characteristics
Constant load 39 kΩ

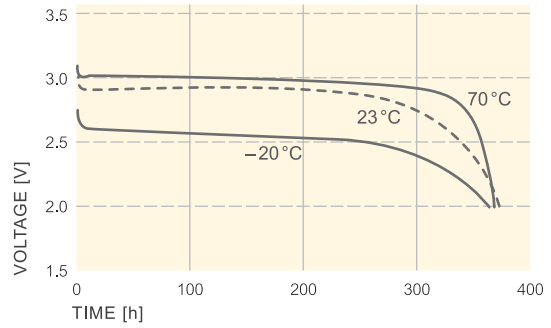

FIG. 24 – CR 1216
Operating voltage vs. current drain
Voltage at 50% discharge

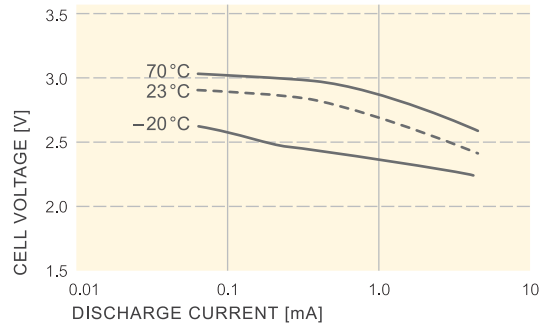

FIG. 25 – CR 1216
Cell capacity vs. discharge current

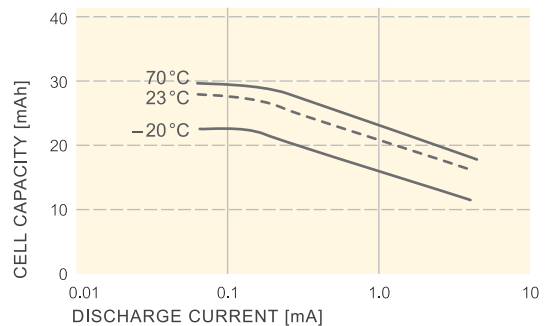

FIG. 26 – CR 2016
 Discharge characteristics
 at room temperature (21°C)

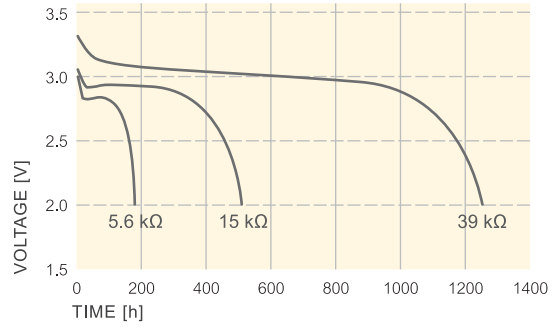

FIG. 27 – CR 2016
 Temperature characteristics
 Constant load 15 kΩ

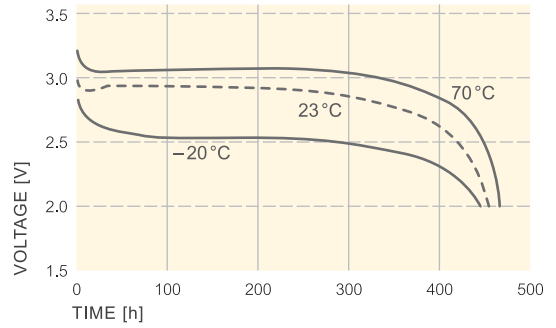

FIG. 28 – CR 2016
 Operating voltage vs. current drain
 Voltage at 50% discharge

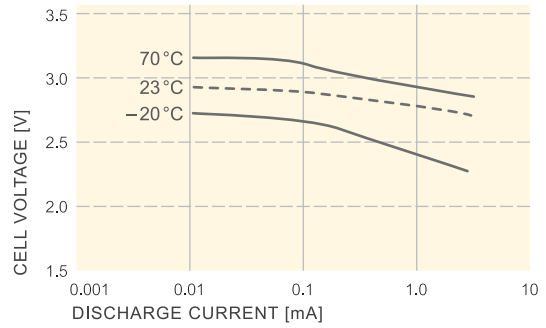

FIG. 29 – CR 2016
 Cell capacity vs. discharge current

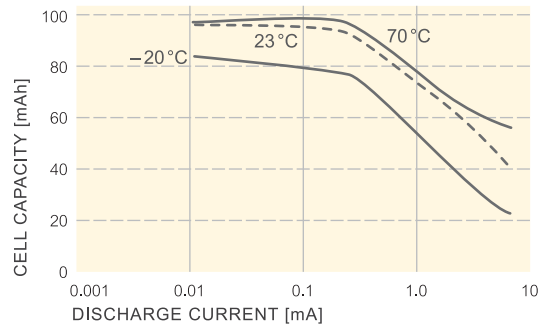

FIG. 30 – CR 2025
 Discharge characteristics
 at room temperature (21°C)

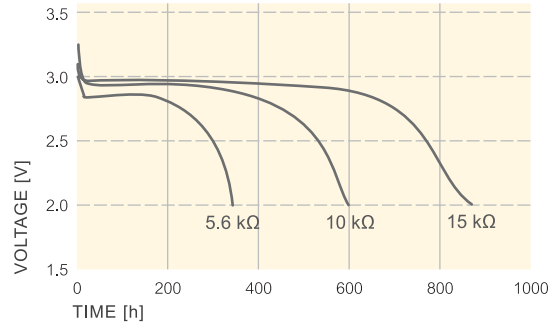

FIG. 31 – CR 2025
 Temperature characteristics
 Constant load 10 kΩ

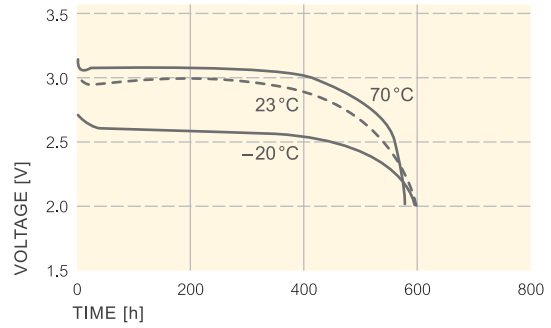

FIG. 32 – CR 2025
 Operating voltage vs. current drain
 Voltage at 50% discharge

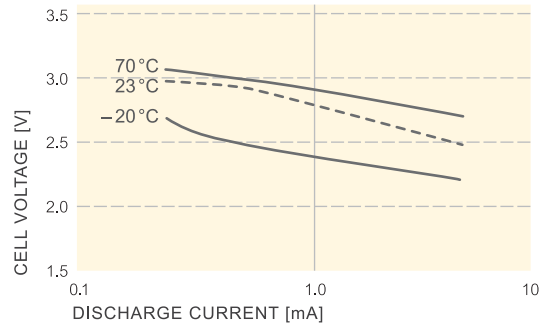

FIG. 33 – CR 2025
 Cell capacity vs. discharge current

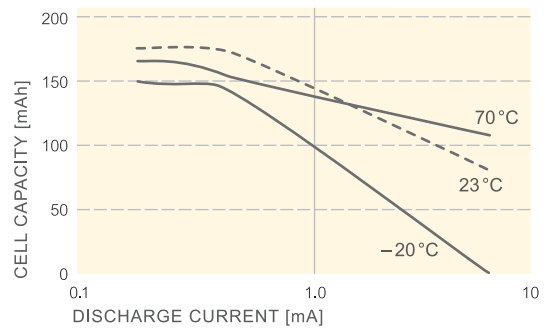

FIG. 34 – CR 2032
 Discharge characteristics
 at room temperature (21°C)

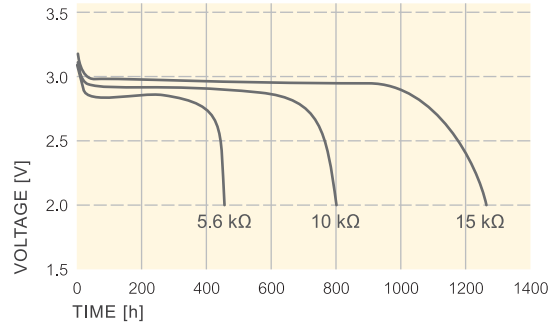

FIG. 35 – CR 2032
 Temperature characteristics
 Constant load 5.6 kΩ

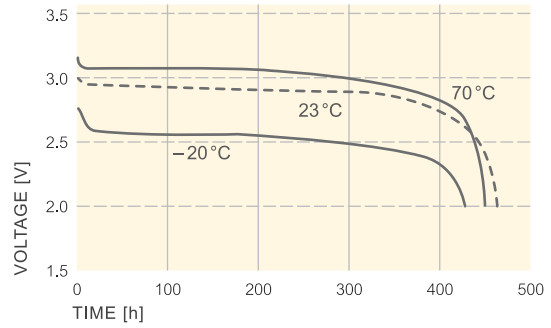

FIG. 36 – CR 2032
 Operating voltage vs. current drain
 Voltage at 50% discharge

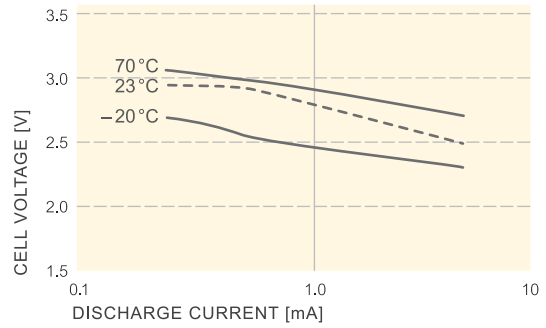

FIG. 37 – CR 2032
 Cell capacity vs. discharge current

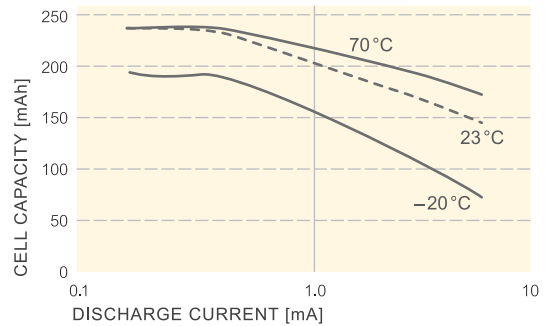

FIG. 38 – CR 2430

Load: cont. 5.6 kΩ: U_b
 Pulse: 2 s/2 h 390 Ω: U_t
 (parallel)
 Internal Resistance R_i calculated from
 U_b and U_t at $R_t = 390 \Omega$ and $T_t = 2s$
 Temperature: $d = 20^\circ C$

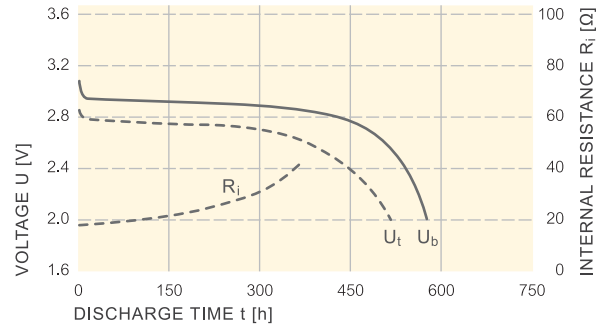

FIG. 39 – CR 2430

Load: cont. 5.6 kΩ (B)
 cont. 15 kΩ (B)
 cont. 270 kΩ (A)
 Mean discharge current: $I_1 = 400 \mu A$
 $I_2 = 180 \mu A$
 $I_3 = 10 \mu A$
 Temperature: $d = 20^\circ C$

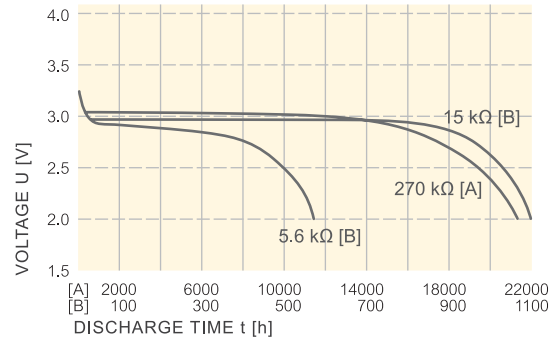

FIG. 40 – CR 2430

Discharge curves at different temperatures
 Load: cont. $R = 15 k\Omega$
 Mean discharge current at
 temperature: $d = 0^\circ C \sim 175 \mu A$
 $d = -10^\circ C \sim 170 \mu A$
 $d = -20^\circ C \sim 155 \mu A$

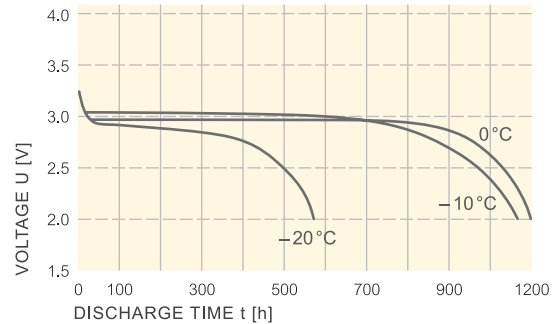
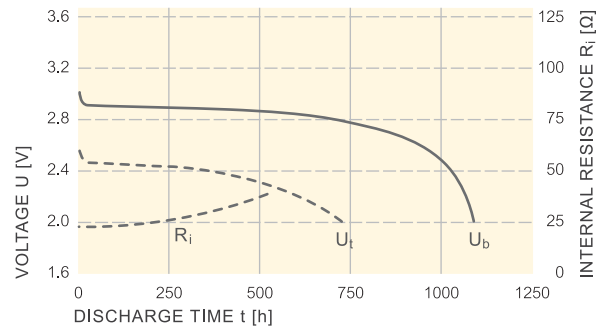
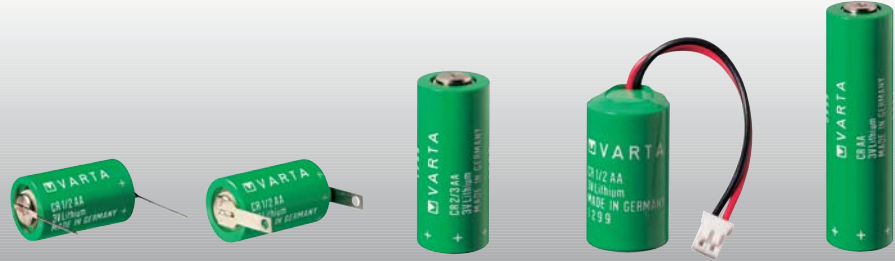

FIG. 41 – CR 2450

Load: cont. 5.6 kΩ: U_b
 Pulse: 2 s/2 h 100 Ω: U_t
 (parallel)
 Internal Resistance R_i calculated from
 U_b and U_t at $R_t = 100 \Omega$ and $T_t = 2s$
 Temperature: $d = 20^\circ C$



3. CR HIGH CAPACITY PRIMARY LITHIUM CYLINDRICAL CELLS



3.1 TYPES – TECHNICAL DATA



| Type | Order No. | Nominal voltage (V) | Nominal capacity at 20°C, down to 2.0 V, load (mAh) | Max. continuous discharge current (mA) | Weight (g) |
|-----------|--------------|---------------------|---|--|------------|
| CR 1/2 AA | 6127 101 301 | 3 | 950 mAh–5.6 kΩ | 10 | 11.5 |
| CR 2/3 AA | 6237 101 301 | 3 | 1.350 mAh–1.0 kΩ | 15 | 15.0 |
| CR AA | 6117 101 301 | 3 | 2.000 mAh–1.0 kΩ | 20 | 21.5 |
| CR 2/3 A | 6238 101 301 | 3 | 1.350 mAh–1.0 kΩ | 15 | 17.0 |

TAB. 6
Technical data, CR High Capacity Primary Lithium Cylindrical Cells

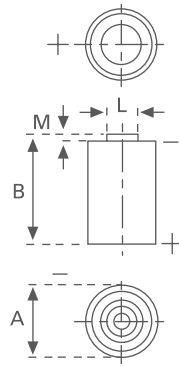

AFIG .42

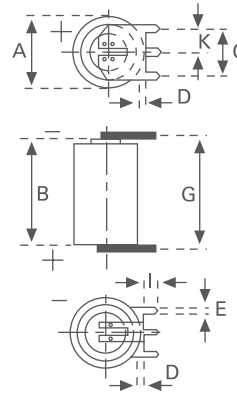

FIG. 43

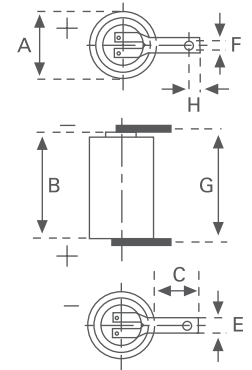

FIG. 44

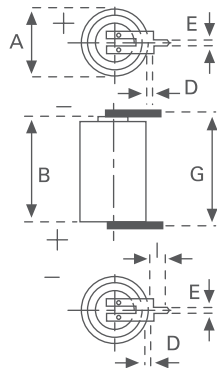
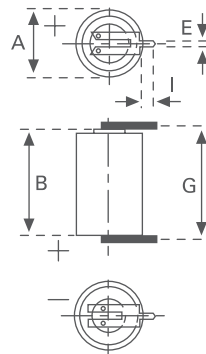

FIG. 45



AFIG. 46

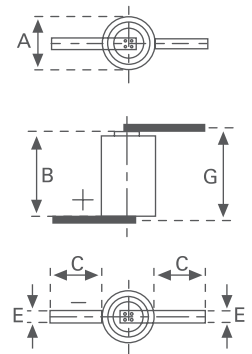

FIG. 47

3.2 ASSEMBLIES

| Type | Order No. | A (Max.) | B | C | D | E | F | G | H | I | K | L | M | Fig. No. | Tags |
|----------------------------|--------------|----------|------|------|-----|------|-----|------|-----|-----|-----|-----|-----|----------|------------------|
| CR 1/2 AA | 6127 101 301 | 14.75 | 25.2 | – | – | – | – | – | – | – | – | 7.0 | 0.6 | 42 | |
| CR 1/2 AA SLF | 6127 201 301 | 14.75 | 25.2 | 10.0 | 1.0 | 1.0 | – | 25.4 | – | 3.0 | 5.0 | – | – | 43 | |
| CR 1/2 AA LF | 6127 301 301 | 14.75 | 25.2 | 10.0 | – | 3.5 | 2.1 | 25.4 | 2.5 | – | – | – | – | 44 | |
| CR 1/2 AA CD | 6127 501 301 | 14.75 | 25.4 | 45.0 | – | – | – | – | – | – | – | – | – | 49 | |
| CR 1/2 AA CD | 6127 601 301 | 14.75 | 25.4 | – | 7.5 | – | – | 33.5 | – | – | – | – | – | 48 | (90°) |
| CR 1/2 AA SLF | 6127 701 301 | 14.75 | 25.2 | – | 1.0 | 1.0 | – | 25.4 | – | 3.0 | – | – | – | 45 | single pin |
| CR 1/2 AA LF | 6127 801 301 | 14.75 | 25.2 | 14.5 | – | 3.0 | – | 25.4 | – | – | – | – | – | 47 | (180°) |
| CR 1/2 AA SLF | 6127 901 301 | 14.75 | 25.2 | – | – | 1.0 | – | 25.4 | – | 3.0 | – | – | – | 46 | short pin |
| CR 1/2 AA TP | 6127 601 381 | 14.75 | 25.2 | 16.5 | – | 0.64 | – | 25.8 | – | – | – | – | – | 50 | terminal pin |
| CR 1/2 AA WC ¹⁾ | 6127 201 390 | 17.5 | 27.0 | 50.0 | – | – | – | – | – | – | – | – | – | 51 | wire & connector |
| CR 2/3 AA | 6237 101 301 | 14.75 | 33.5 | – | – | – | – | – | – | – | – | 7.0 | 0.6 | 42 | |
| CR 2/3 AA SLF | 6237 201 301 | 14.75 | 33.5 | 10.0 | 1.0 | 1.0 | – | 33.7 | – | 3.0 | 5.0 | – | – | 43 | |
| CR 2/3 AA LF | 6237 301 301 | 14.75 | 33.5 | 10.0 | – | 3.5 | 2.1 | 33.7 | 2.5 | – | – | – | – | 44 | |
| CR 2/3 AA CD | 6237 501 301 | 14.75 | 33.5 | 45.0 | – | – | – | – | – | – | – | – | – | 49 | |
| CR 2/3 AA SLF | 6237 701 301 | 14.75 | 33.5 | – | 1.0 | 1.0 | – | 33.7 | – | 3.0 | – | – | – | 45 | single pin |
| CR 2/3 AA SLF | 6237 901 301 | 14.75 | 33.5 | – | – | 1.0 | – | 33.7 | – | 3.0 | – | – | – | 46 | short pin |
| CR AA | 6117 101 301 | 14.75 | 50.0 | – | – | – | – | – | – | – | – | 7.0 | 0.6 | 42 | |
| CR AA SLF | 6117 201 301 | 14.75 | 50.0 | 10.0 | 1.0 | 1.0 | – | 50.2 | – | 3.0 | 5.0 | – | – | 43 | |
| CR AA LF | 6117 301 301 | 14.75 | 50.0 | 10.0 | – | 3.5 | 2.1 | 50.2 | 2.5 | – | – | – | – | 44 | |
| CR AA CD | 6117 501 301 | 14.75 | 50.2 | 45.0 | – | 3.5 | – | – | – | – | – | – | – | 49 | |
| CR AA SLF | 6117 701 301 | 14.75 | 50.0 | – | 1.0 | 1.0 | – | 50.2 | – | 3.0 | – | – | – | 45 | single pin |
| CR AA WC ¹⁾ | 6117 201 390 | 18 | 51.0 | 50.0 | – | – | – | – | – | – | – | – | – | 51 | wire & connector |
| CR 2/3 A | 6238 101 301 | 17 | 33.5 | – | – | – | – | – | – | – | – | 7.0 | 0.6 | 42 | |
| CR 2/3 A LF | 6238 301 301 | 17 | 33.5 | 10.0 | – | 3.5 | 2.1 | 33.7 | 2.5 | – | – | – | – | 44 | |
| CR 2/3 A CD | 6238 501 301 | 17 | 33.5 | 45.0 | – | – | – | – | – | – | – | – | – | 49 | |

TAB. 7

Material: nickel plated sheet-steel, tag thickness: 0.15 mm till 0.25 mm. SLF: tip tinned, all types in green shrink sleeve.

¹⁾ using connector: JST type: PHR2 (Other connector types available on request.)

Custom made assemblies are available on request for large volume.

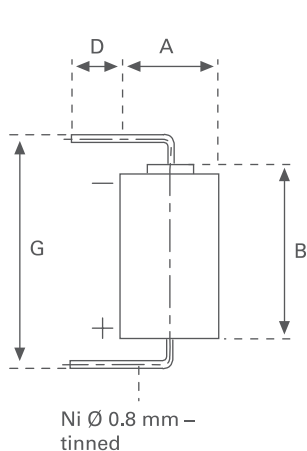

FIG. 48

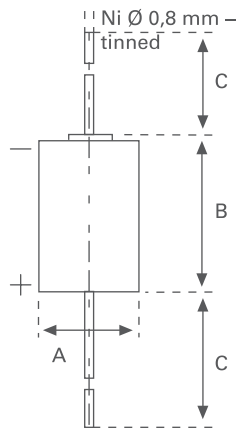

FIG. 49

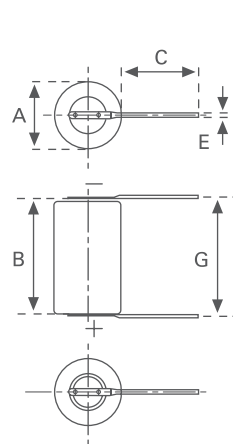

FIG. 50

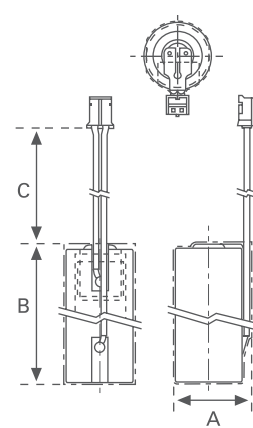

FIG. 51

3.3 PERFORMANCE DATA

FIG. 52 – CR 1/2 AA
 FIG. 56 – CR 2/3 AA
 FIG. 60 – CR AA

Discharge characteristics
 at room temperature (21°C)

FIG. 52
 CR 1/2 AA

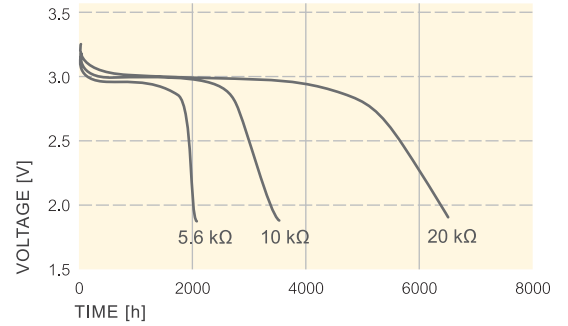

FIG. 53 – CR 1/2 AA
 FIG. 57 – CR 2/3 AA
 FIG. 61 – CR AA

Temperature characteristics
 at 5.6 kΩ

FIG. 53
 CR 1/2 AA

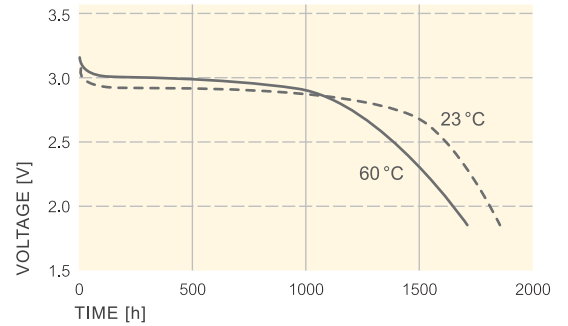

FIG. 54 – CR 1/2 AA
 FIG. 58 – CR 2/3 AA
 FIG. 62 – CR AA

Operating voltage vs. current drain,
 Voltage at 50% discharge

FIG. 54
 CR 1/2 AA

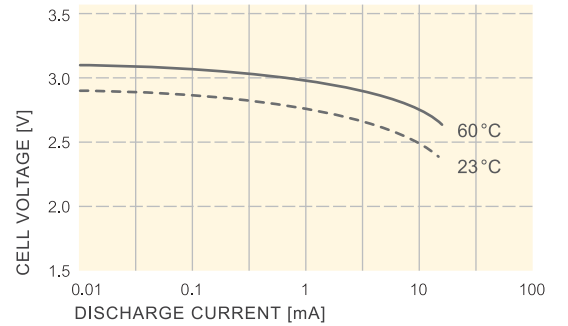

FIG. 55 – CR 1/2 AA
 FIG. 59 – CR 2/3 AA
 FIG. 63 – CR AA

Cell capacity vs. discharge current

FIG. 55
 CR 1/2 AA

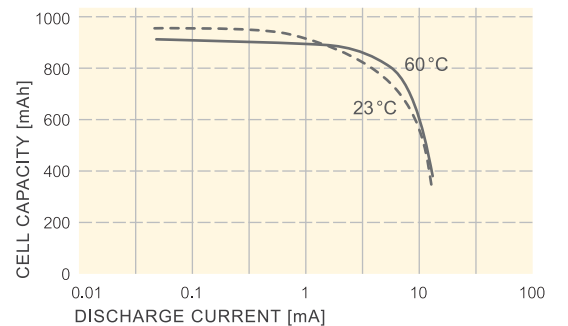

FIG. 56
CR 2/3 AA

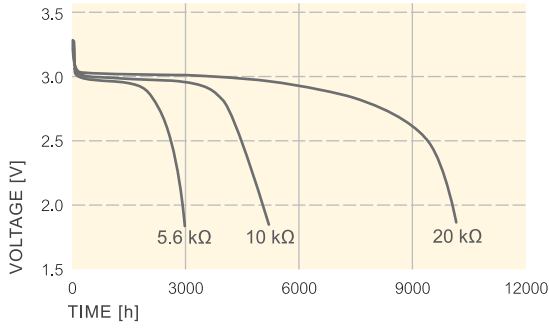

FIG. 60
CR AA

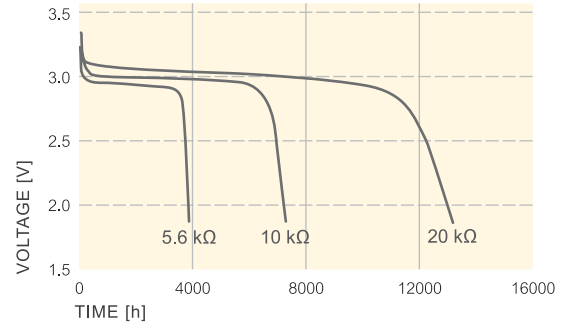

FIG. 57
CR 2/3 AA

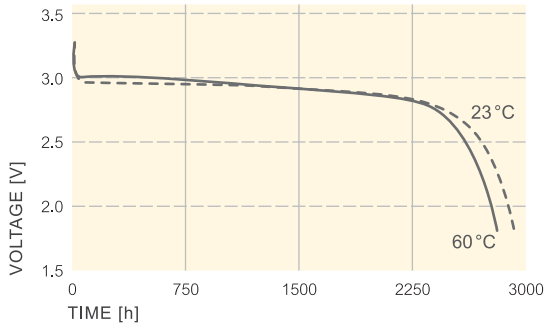

FIG. 61
CR AA

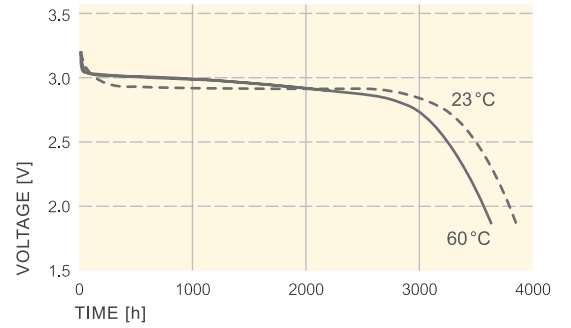

FIG. 58
CR 2/3 AA

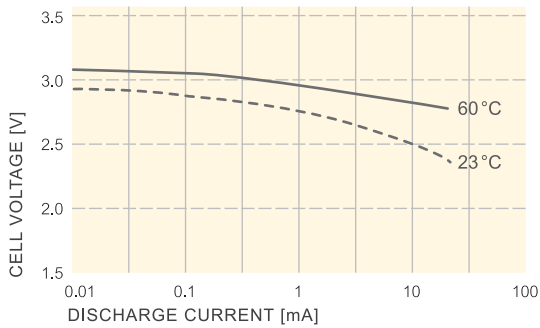

FIG. 62
CR AA

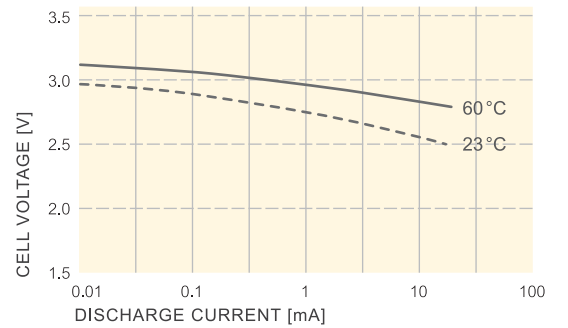

FIG. 59
CR 2/3 AA

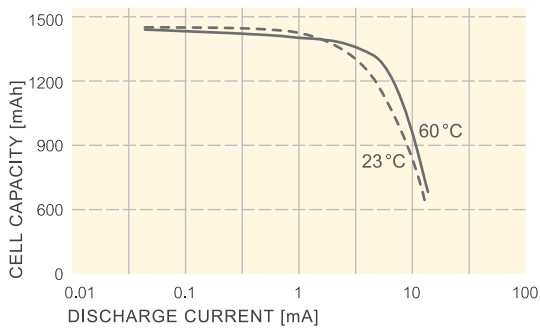

FIG. 63
CR AA

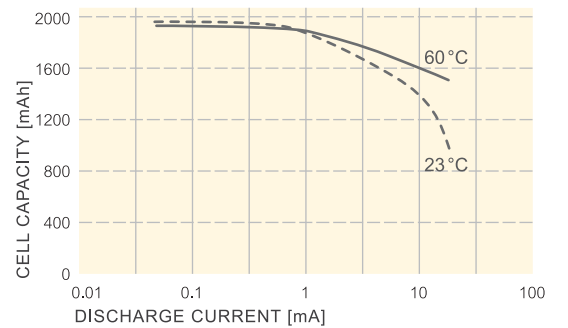

FIG. 64 – CR 2/3 A
 Discharge characteristics
 at room temperature (21°C)

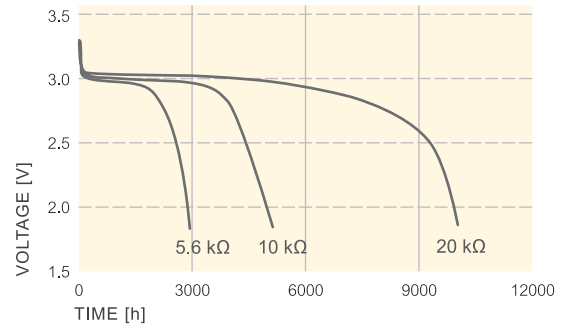

FIG. 65 – CR 2/3 A
 Temperature characteristics
 Constant load 5.6 kΩ

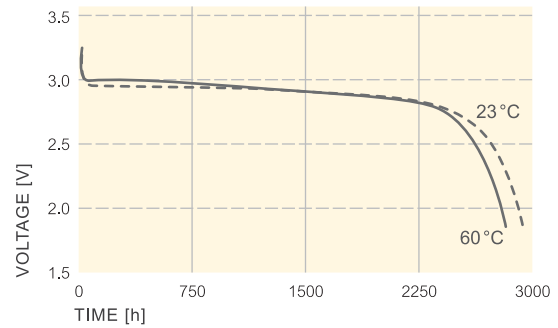

FIG. 66 – CR 2/3 A
 Operating voltage vs. current drain
 Voltage at 50% discharge

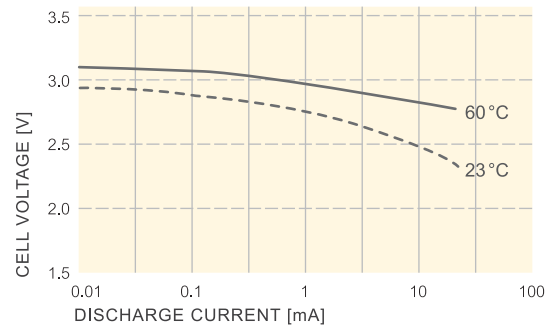
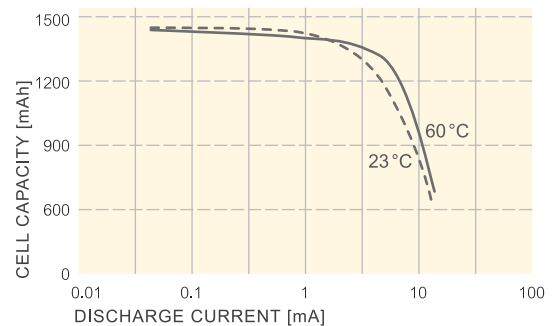

FIG. 67 – CR 2/3 A
 Cell capacity vs. discharge current



4. CR HIGH POWER PRIMARY LITHIUM CYLINDRICAL CELLS



4.1 TYPES – TECHNICAL DATA



CR 2/3 AH



CR 123 A



CR 2

| Type | Order No. | Nominal voltage (V) | Nominal capacity at 20 °C, load (mAh) | Max. continuous discharge current ¹⁾ (mA) | Weight (g) |
|-----------|--------------|---------------------|---------------------------------------|--|------------|
| CR 2/3 AH | 6215 101 501 | 3 | 1500 mAh–200 Ω | 1500 | 16 |
| CR 123 A | 6205 210 501 | 3 | 1500 mAh–200 Ω/2.0 V | 1400 | 17 |
| CR 2 | 6206 210 501 | 3 | 850 mAh–200 Ω/1.8 V | 885 | 11 |

TAB. 8

Technical data, CR High Power Primary Lithium Cylindrical Cells

¹⁾ Current value for obtaining 50% capacity ²⁾ in blister card (1 pc)

4.2 ASSEMBLIES

| Type | Order No. | A | B | C | D | E | F | G | H | I | K | L | M | Fig. No. | Tags |
|---------------|--------------|----------------------|----------------------|------|---|-----|---|------|---|-----|---|----------|------|----------|------|
| CR 2/3 AH | 6215 101 501 | 17.0 ₋₁ | 33.9 _{-1.5} | - | - | - | - | - | - | - | - | 6.3 ±0.2 | 1.0 | 68 | - |
| CR 2/3 AH SLF | 6215 201 013 | 16.5 | 33.3 | 10.0 | - | 1.0 | - | 33.7 | - | 3.0 | - | - | - | 70 | - |
| CR 123 A | 6205 210 501 | 17.0 ₋₁ | 34.5 _{-0.6} | - | - | - | - | - | - | - | - | 6.4 | 1.29 | 68 | - |
| CR 2 | 6206 210 501 | 15.6 _{-0.5} | 27.0 | - | - | - | - | - | - | - | - | 6.5 | 0.7 | 68 | - |

TAB. 9

Material: nickel plated sheet-steel, tag thickness: 0.15 mm till 0.25 m. SLF: tip tinned.

Custom made assemblies are available on request for large volume.

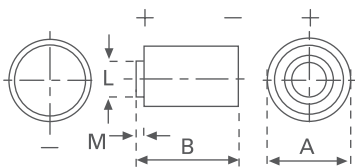

FIG. 68

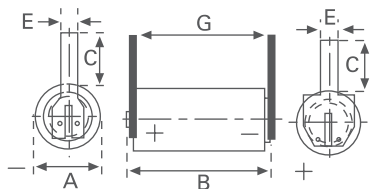

FIG. 69

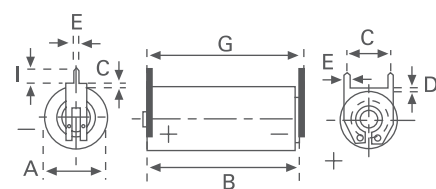

FIG. 70

4.3 PERFORMANCE DATA

FIG. 71 – CR 2/3 AH
Discharge characteristics
at room temperature (21°C)

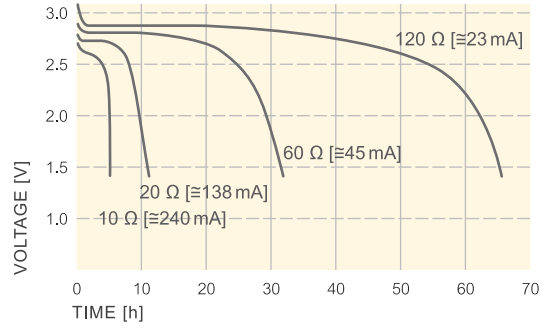

FIG. 72 – CR 2/3 AH
Temperature characteristics
Constant load 5.6 kΩ

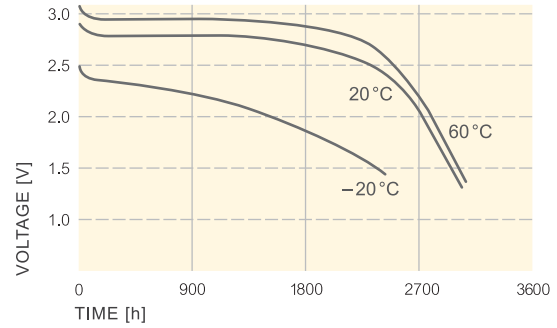

FIG. 73 – CR 2/3 AH
Pulse discharge characteristics

¹⁾ Load: 0.9 A, 3 sec. on, 27 sec. off
²⁾ After storage at 60°C/100 days

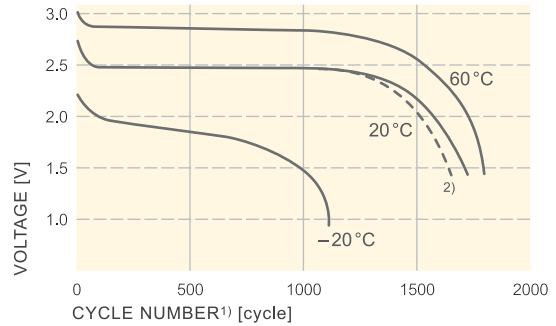

FIG. 74 – CR 2/3 AH
Typical discharge curve
Load: cont. 560 Ω
Pulse load: 2 sec./min 3 Ω
(parallel)

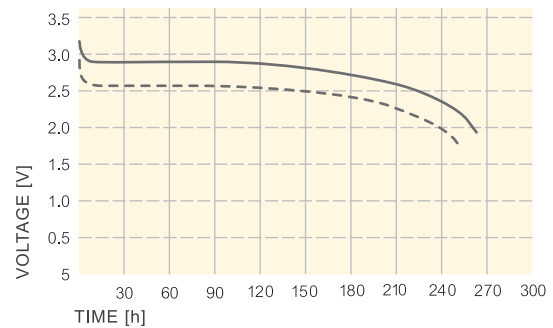

FIG. 75 – CR 123 A
 Discharge characteristics
 at room temperature (21°C)

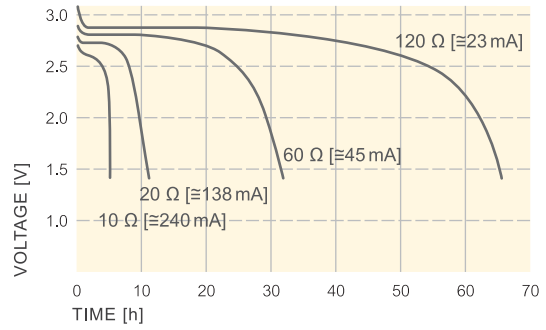

FIG. 76 – CR 123 A
 Temperature characteristics
 Constant load 5.6 kΩ

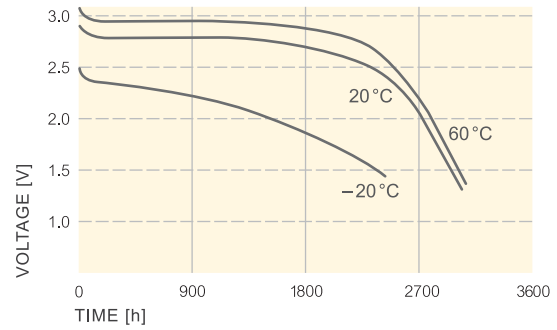

FIG. 77 – CR 123 A
 Pulse discharge characteristics

- 1) Load: 0.9 A, 3 sec. on, 27 sec. off
- 2) After storage at 60°C/100 days

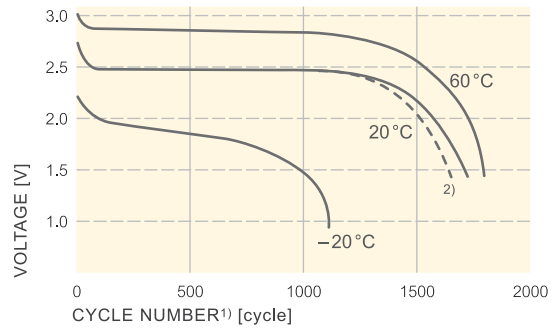

FIG. 78 – CR 123 A
 Typical discharge curve
 Load: cont. 560 Ω
 Pulse load: 2 sec./min 3 Ω
 (parallel)

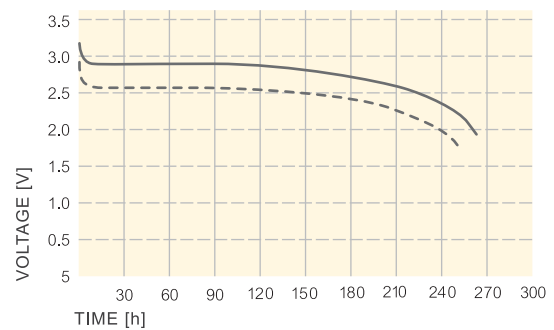

FIG. 79 – CR 2
Discharge characteristics
at room temperature (21°C)

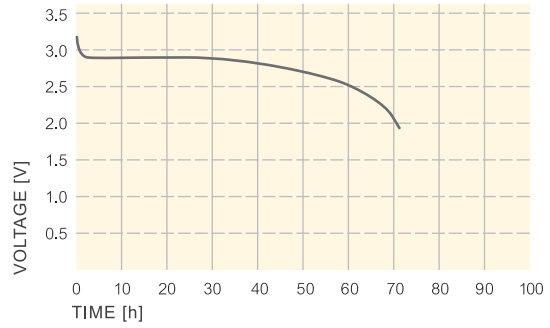

FIG. 80 – CR 2
Pulse discharge characteristics

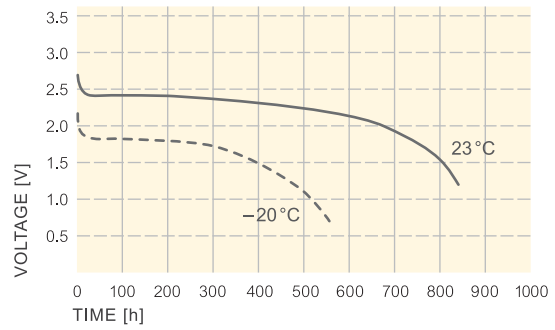
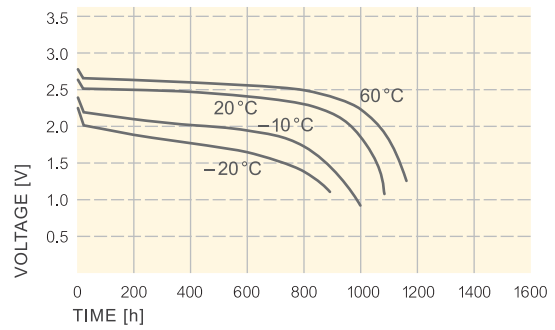

FIG. 81 – CR 2
Discharge temperature characteristics



5. GENERAL DESIGN CHARACTERISTICS

Battery Selection

In order to ensure optimum battery performance for the primary CR Button, the cylindrical CR High Power and cylindrical High Capacity cells, we suggest consideration of the following design-in requirements. They are the nominal and operating voltage, load current and profile,

the duty cycle, temperature requirements and shelf life for the application. These characteristics for each battery type must be evaluated against the design requirements to select the most appropriate product that fulfills these requirements.

Design-in Considerations

VARTA Microbattery Primary Lithium Batteries offer light-weight packaged power for a variety of portable electric and electronic equipment. They are suitable as a main or standby power source for memory (RAM) and Real-Time clock (RTC) applications.

The Lithium Batteries are blocked from the power supply by means of a diode to prevent discharge of the battery into the DC supply during shut down.

The voltage drop across D1 should be taken into account as the minimum voltage of the load that has to be maintained under all circumstances.

Blocking diode D2 and D3 prevents the battery from being charged through the power supply. The amount of accumulated reverse current (IR) should be kept around 1% of the cell's typical capacity during its standby life time.

A maximum of 5 μ A continuously must not be exceeded.

In the absence of a DC supply voltage, the lithium battery supplies the load with the necessary power.

As diodes fail at low current levels by an alloy-effect causing a severe reduction in impedance, an additional safety device must be incorporated.

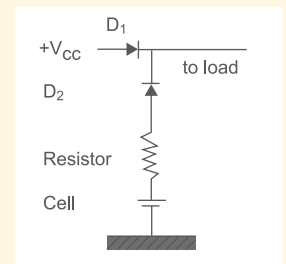

FIG. 76

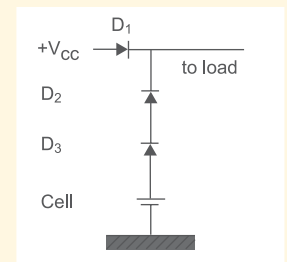

FIG. 77

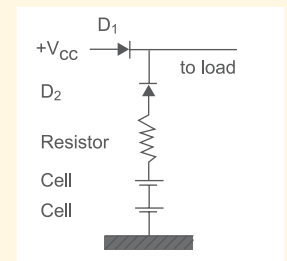

FIG. 78

Using 2 cells when 6 V is used in series

UL-Recognition

All **VARTA** Microbattery Lithium Cells and Batteries listed in Tab.10 are recognized by Underwriters Laboratories Inc. under UL-file number MH 13654 (N).

The cells are marked with the Recognized Component Mark.

Underwriters Laboratories requires for lithium cells/ batteries a circuit, which must contain a protective component to prevent charging. In case of diode failure a current limiting resistor must be chosen according to the values listed in Tab. 10.

Please also pay attention to the Safety Guidelines on page 34.

For safety tests of the cells, "UL" requires either an additional diode, or a resistor, limiting the current to a safe level of 4 mA (for all cylindrical CR... A(A) lithium mass cells).

It should be noted that the value of the resistor has to be calculated using the higher power supply voltage – not the battery voltage.

The supply voltage to the load can be calculated by the battery voltage drop across the diode and the resistor.



Trademark of Underwriters Laboratories

| Button Cells | | Cylindrical Cells | |
|--------------|--------------------------------------|-------------------|--------------------------------------|
| Type | Max. safe reverse current acc. to UL | Type | Max. safe reverse current acc. to UL |
| CR 1216 | 3 mA | High Capacity | |
| CR 1220 | 3 mA | CR 1/2 AA | 4 mA |
| CR 1616 | 4 mA | CR 2/3 AA | 4 mA |
| CR 1620 | 2.5 mA | CR AA | 4 mA |
| CR 2016 | 4 mA | CR 2/3 A | 4 mA |
| CR 2025 | 5 mA | | |
| CR 2032 | 5 mA | High Power | |
| CR 2320 | 5 mA | CR 2/3AH | 25 mA |
| CR 2430 | 15 mA | CR 123 A | 10 mA |
| CR 2450 | 15 mA | CR 2 | 20 mA |
| CR 1/3 N | 2 mA | | |

TAB. 10
All listed cells/batteries are recognized by UL-recognition.

Printed Circuit Board Mounting

Never solder on the body of the battery directly, use a battery equipped with PC-mount terminals. When using automatic soldering apply 250–270 °C within 5 seconds. Make sure that the battery is not suspended or dropped into the soldering bath.

Do not heat above 80 °C to avoid leakage caused by deterioration in the battery's performance.

5.1 SAFETY TESTS

For safety aspects please consult Varta Microbattery before performing these extreme tests:

Compression Test 1120 kg

- no significant electrolyte loss
- no rupturing

In Short Circuit Condition 24 h, 0.1 Ω

- after 24 h the bottom of the cell is curved by only 0.1 mm; diameter unchanged
- no electrolyte creepage or loss
- no rupturing

Test at 150°C for 2 Hours

- no electrolyte creepage or loss
- no rupture
- no fire
- no explosion
- open circuit voltage almost unchanged at 3.2 V
- the cell base bowed, causing cell height to increase by 1 mm, diameter unchanged

Puncture Test total Penetration of the Cell by a Nail Ø 3mm

- no splashing or pressurized electrolyte loss
- no rupturing

Short Circuit

In table 11 the temperature is listed at short circuit at an ambient temperature of 20°C, 40°C and 70°C.

| Ambient temperature | CR 1/2 AA | CR 2/3 AA | CR AA |
|---------------------|-----------|-----------|-------|
| 20°C | 24°C | 28°C | 24°C |
| 40°C | 50°C | 50°C | 47°C |
| 70°C | 80°C | 84°C | 77°C |

TAB. 11

Vibration Test

| Vibration test | Result |
|---|---|
| Frequency range 5 Hz – 55 Hz – 500 Hz – 55 Hz – 5 Hz | Without changing of the electrical values the following Li-cell can be exposed to this vibration test: ■ CR 1/2 AA ■ CR 2/3 AA ■ CR AA |
| Amplitude at frequency range: 5 to 55 Hz: ± 0.75 mm | |
| Acceleration at frequency range: 55 Hz to 500 Hz: 100 m/s ² | |
| Cycle duration: 15 min | |
| Oscillation time of each main axis: 3 h | |

TAB. 12

Temperature Characteristics

FIG. 79

CR 1/2 AA, Temperature characteristics
Conditions: 20 h/20°C: 15 kΩ,
4 h/at various temp.: 270 kΩ

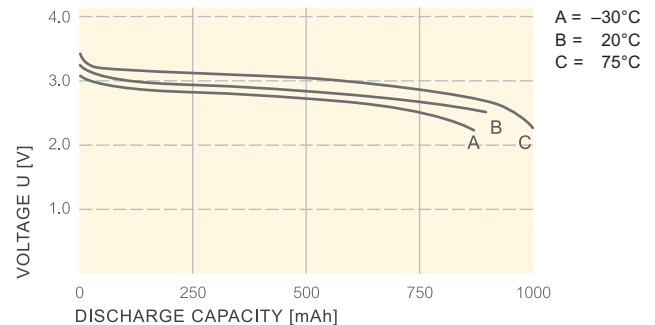

5.2 SAFETY GUIDELINES

Safety and Handling Issues

We recommend that attention begins to the design and implementation of our Lithium-Manganese Dioxide Button/Cylindrical Cells to ensure superior operating performance. With our Lithium-Manganese Dioxide Batteries, the appropriate precautions must be taken to avoid physical and electrical abuse, otherwise the batteries can be hazardous if not used properly. To avoid such incidents, we would suggest you review the following safety and handling precautions for your potential application:

- **Do not heat. Nor dispose of in fire**
If heated, the plastic materials in the cell such as the gasket and separator may be damaged, causing leakage. The heat generated by a short circuit inside the batteries may lead to bursting or combustion. If disposed of in fire, batteries may violently rupture.
- **Do not charge (Lithium Primary Battery CR Series)**
When a Lithium Primary Battery is charged, gas is generated inside the battery and can result in swelling, heat generation, leakage, violent rupture or potential fire.
- **Avoid forced discharge**
When batteries are force-over discharged with an external power source, the voltage drops to under 0.0 V (reverse electrode), and inner gas is generated. This can lead to swelling, heating, leakage, violent rupture and/or potential fire.
- **Do not short circuit**
If the positive and negative terminals come into contact with each other or with a metal object, this can cause a short circuit, generating heat. If the batteries are stacked on top of each other or mixed, the resulting short-circuit can lead to heat generation, leakage, violent rupture or fire.
- **Do not disassemble, apply excessive pressure or deform**
If a battery is forcefully disassembled, gas may be generated which may cause throat irritation, or the lithium metal may generate heat, causing fire. If deformed under pressure or under impact, distortion of the seal may lead to leakage, or a short circuit inside the battery may lead to potential safety hazards.
- **Do not use with other battery types or old batteries with fresh cells**
If different types of batteries are used together, or fresh are used with old ones, the difference in characteristics of voltage, capacity, etc. may cause overdischarge of the battery which is exhausted first, leading to swelling, bursting or fire.

- **Observe the (+) and (-) polarity**

If the batteries cell polarity is reversed by inserting the battery backwards, depending on the equipment, a short circuit or over discharging may result in a potential safety hazard.

- **Do not swallow**

Store batteries in a safe location, out of the reach of babies and small children. Also, make sure that batteries cannot be easily removed from equipment in which they are used. If swallowed by mistake, consult a doctor immediately.

- **Do not store in direct sunlight or rain**

Store batteries in a place not subject to direct sunlight. Make sure the area is dry and is approximately 20°C. Storage in areas with higher temperature, humidity or exposure to rain may cause deterioration in battery quality and durability.

- **Soldering**

Do not solder or weld directly to the cell's surface. Use preassembled cells with tabs or leads.

- **Do not throw into water**

This can result in corrosion and the generation of combustible gas.

5.3 TRANSPORTATION OF VARTA MICROBATTERY LITHIUM CELLS AND BATTERIES

In general, Lithium batteries are subjected to transport regulations depending on the means of transportation. But all batteries sold by VARTA Microbattery which are listed in this handbook are not subjected to the transport regulations of dangerous goods*, because they fulfil the following requirements (Special provisions ADR 188, IATA 45, IMDG 188, DOT / 49 CFR 173.185):

- The batteries do not contain more than 1 g of Lithium per cell respectively 2 g Lithium per battery.
- The batteries passed the safety tests according to clause 38.3 of the UN handbook of tests and criteria.
- The batteries are isolated in the packaging to avoid short circuits.
- The packs are marked with a warning notice that clearly states that the pack contains Lithium batteries and must be quarantined, inspected and repacked if damaged.
- The total mass must not exceed 30 kg per pack.

***Transportation of primary Lithium Batteries in the USA**

Effective December 29, 2004, the U.S. Department of Transport requires that the outside of each package that contains primary lithium batteries, regardless of size or number of batteries, is to be labeled with the following statement: "PRIMARY LITHIUM BATTERIES – FORBIDDEN FOR TRANSPORT ABOARD PASSENGER AIRCRAFT". The labeling requirement covers shipments via highway, rail, vessel or cargo-only aircraft and covers all shipments inside, into or out of the US. The label must be in contrasting color and the letters must be 12 mm (0.5 in) in height for packages weighing more than 30 kg and 6 mm (0.25 in) in height for packages weighing less than 30 kg.

General remark

The exemptions from dangerous goods regulations are only applicable with respect to the delivery form/packaging in which the lithium batteries are dispatched by VARTA Microbattery. Any re-packaging or assembly of cells is in the responsibility of the customer and makes new safety tests necessary. Note that the maximum amount of lithium or lithium-equivalent according to special provisions 188 (ADR) or A45 (IATA) may be exceeded as a consequence of assembly. Used lithium batteries have to be handled like fresh ones.

We do not recommend to weld terminals to the batteries; this should only be done by qualified personnel.

5.4 APPLICATION CHECK LIST

Customer:

Application:

Requested quantity:

Batteries per annum:

Type of battery:

Primary power source:

MBU:

U_{max} :

U_{min} :

U_{cutoff} :

I_{max} :

I_{min} :

$I_{average}$:

Current profile:

Operating temperature:

max (°C):

min (°C):

average (°C):

Temperature profile:

Storage temperature

max (°C):

min (°C):

average (°C):

Storage time:

Operating time:

Dimensions:

Remarks:

Product Portfolio

| Primary Batteries | | | | | |
|---|---------------------------------|---|---|---|---|
|  | VARTA CardPower (Li-Polymer) |  | Lithium Cylindrical Cells |  | Zinc Air Cells |
|  | Alkaline Batteries |  | Lithium Button Cells |  | Silver Oxide Button Cells |
| Rechargeable Batteries | | | | | |
|  | Li-Polymer |  | Ni-MH Button Cells (V...H / HR / HT / HRT) |  | Cylindrical & Prismatic Li-Ion & Ni-MH Cells |

Global Contacts

Germany and Central Europe
VARTA Microbattery GmbH
 Daimlerstraße 1
 73479 Ellwangen, Germany
 Tel +49 79 61 921 - 0
 Fax +49 79 61 921 - 553

Asia Pacific

VARTA Microbattery Pte. Ltd.
 300, Tampines Avenue 5, #05-01
 Tampines Junction, 529653 Singapore
 Tel +65 6 260 58 01
 Fax +65 6 260 58 12

China

Hongkong
 VARTA Microbattery Pte. Ltd.
 Rm. 1702-3, 17/F., Fullerton Centre
 19 Hung to Road, Kwun Tong
 Kowloon, Hongkong
 Tel +852 28 98 83 73
 Fax +852 28 97 76 09

Beijing

VARTA Microbattery Pte. Ltd.
 Room 05, 11/F., Xinyi Commercial Building
 No. 3A Xinyijiyuan
 Chongwenmenwai Avenue
 Chongwen District, Beijing
 China 100062
 Tel +86 10 67 09 60 57, 67 09 60 58
 Fax +86 10 67 09 60 59

Shanghai

VARTA Microbattery (Shanghai) Co. Ltd.
 Block 3, Shanghai Pudong Chuansha
 Industrial Park
 No. 6999 Chuansha Road
 Pudong New Area
 201202 Shanghai, China
 Tel +86 21 58 59 83 85
 Fax +86 21 58 59 33 13

Japan

VARTA Microbattery Pte. Ltd.
 Kyobashi Y'SUS Bldg, 3F.
 1-6-12, Kyobashi, Chuo-Ku
 Tokyo 104-0031, Japan
 Tel +81 3 35 67 81 71
 Fax +81 3 35 67 81 75

South Korea

VARTA Microbattery Pte. Ltd.
 411-1 KCAT Bldg.
 159-6 Samsung-dong, Kangnam-gu
 Seoul 135-728 Korea
 Tel +82 2 551 53 45
 Fax +82 2 551 53 44

Taiwan

VARTA Microbattery Pte. Ltd.
 11F-4, No. 130, Section 2
 Chung Hsiao East Road
 Taipei 10053, Taiwan
 Tel +886 2 33 93 15 57
 Fax +886 2 33 93 15 56

Scandinavia

VARTA Microbattery Nordic
 Langebjergvaenget 8 B, 1.TV
 DK-4000 Roskilde, Denmark
 Tel +45 24 24 80 00
 Fax +45 46 75 01 50

America

VARTA Microbattery, Inc.
 1311 Mamaroneck Avenue, Suite 120
 White Plains, NY 10605, USA
 Tel +1 914 592 25 00
 Fax +1 914 345 04 88

UK and Ireland

VARTA Microbattery GmbH
 17 Progress Business Centre
 Whittle Parkway, Slough SL 1 6DQ, GB
 Tel +44 16 28 60 79 30
 Fax +44 16 28 60 79 39

France

VARTA Microbattery SARL
 12 - 14, Rue Raymond RIDEL
 92250 La Garenne Colombes, France
 Tel +33 1 47 84 84 54
 Fax +33 1 47 84 28 32

Italy

VARTA Microbattery Italia
 Stradone S. Fermo, 19
 37121 Verona, Italy
 Tel +39 045 800 16 15
 Fax +39 045 59 18 78

Distributors Distributors and representations in all major countries world wide. Consult our Webpage.
Internet For e-mail contact please visit: <http://contact.varta-microbattery.com>
 For more information please visit our website: www.varta-microbattery.com

VARTA Microbattery is a Company of
 Montana Tech Components AG,
 Hauptstrasse 35, 5737 Menziken, Switzerland

MONTANA
 TECH COMPONENTS