

REV.	DESCRIPTION	DRAWN	CHECKED	APPROVED
A	NEW RELEASE	HP 24/06/05		

Female Terminal

Wire Range		O.D of Wire
Section Area (mm ²)	AWG#	mm
0.08~0.33	28~22	1.2~1.9

Female Terminal

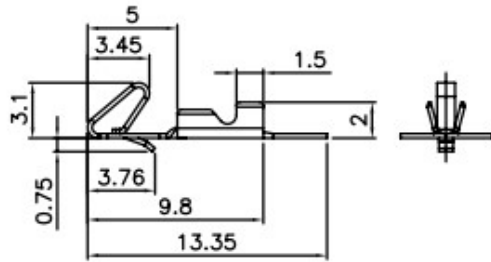

Female Housing

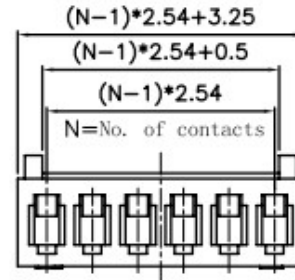
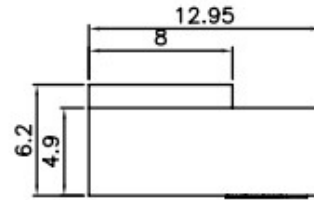

MAIN SPECIFICATIONS

- Housing material: NYLON 66
- Wire range: AWG#28~#22
- Rated voltage: 250V
- Rated current: 1A
- Contact resistance: ≤ 30mΩ
- Insulation resistance: ≥ 1000MΩ
- Withstanding voltage: 500V,AC 1 minute
- Temperature range: -25 ~ +85°C
- Recommend PC board thickness:1.6mm

Male Right Angle

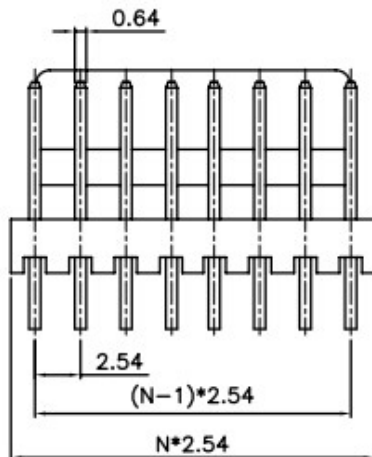

N=No. of contacts

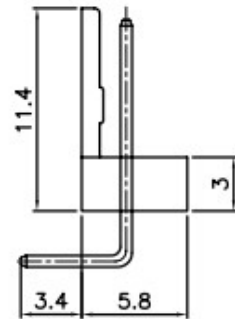

Male V/T TYPE

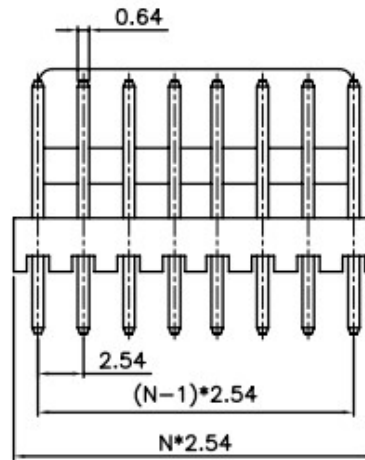

N=No. of contacts

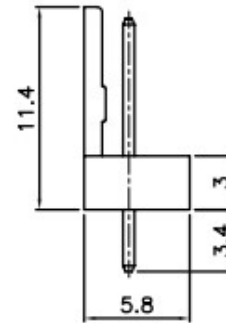

GENERAL TOLERANCE		ANGLE TOLERANCE		PROJECTION		TITLE	P.C.B CONNECTOR 2.54mm																																																				
X.	±0.60	X.	±5°	UNITS	mm																																																						
.X	±0.38	.X	±3°	SHEET SIZE	A4																																																						
.XX	±0.25	.XX	±2°	<table border="0"> <tr> <td>WF-02 war 2.54 mm</td> <td>WF-06 war 2.54 mm</td> <td>WF-10 war 2.54 mm</td> <td>WF-14 war 2.54 mm</td> <td>WF-16S</td> <td>HU-09 war 2.54 mm</td> </tr> <tr> <td>WF-02R war 2.54 mm</td> <td>WF-06R war 2.54 mm</td> <td>WF-10R war 2.54 mm</td> <td>WF-14R war 2.54 mm</td> <td>HU-02 war 2.54 mm</td> <td>HU-10 war 2.54 mm</td> </tr> <tr> <td>WF-03 war 2.54 mm</td> <td>WF-07 war 2.54 mm</td> <td>WF-11 war 2.54 mm</td> <td>WF-14S</td> <td>HU-03 war 2.54 mm</td> <td>HU-11 war 2.54 mm</td> </tr> <tr> <td>WF-03R war 2.54 mm</td> <td>WF-07R war 2.54 mm</td> <td>WF-11R war 2.54 mm</td> <td>WF-15 war 2.54 mm</td> <td>HU-04 war 2.54 mm</td> <td>HU-12 war 2.54 mm</td> </tr> <tr> <td>WF-04 war 2.54 mm</td> <td>WF-08 war 2.54 mm</td> <td>WF-12 war 2.54 mm</td> <td>WF-15R war 2.54 mm</td> <td>HU-05 war 2.54 mm</td> <td>HU-13 war 2.54 mm</td> </tr> <tr> <td>WF-04R war 2.54 mm</td> <td>WF-08R war 2.54 mm</td> <td>WF-12R war 2.54 mm</td> <td>WF-15S</td> <td>HU-06 war 2.54 mm</td> <td>HU-14 war 2.54 mm</td> </tr> <tr> <td>WF-05 war 2.54 mm</td> <td>WF-09 war 2.54 mm</td> <td>WF-13 war 2.54 mm</td> <td>WF-16 war 2.54 mm</td> <td>HU-07 war 2.54 mm</td> <td>HU-15 war 2.54 mm</td> </tr> <tr> <td>WF-05R war 2.54 mm</td> <td>WF-09R war 2.54 mm</td> <td>WF-13R war 2.54 mm</td> <td>WF-16R war 2.54 mm</td> <td>HU-08 war 2.54 mm</td> <td>HU-16 war 2.54 mm</td> </tr> </table>								WF-02 war 2.54 mm	WF-06 war 2.54 mm	WF-10 war 2.54 mm	WF-14 war 2.54 mm	WF-16S	HU-09 war 2.54 mm	WF-02R war 2.54 mm	WF-06R war 2.54 mm	WF-10R war 2.54 mm	WF-14R war 2.54 mm	HU-02 war 2.54 mm	HU-10 war 2.54 mm	WF-03 war 2.54 mm	WF-07 war 2.54 mm	WF-11 war 2.54 mm	WF-14S	HU-03 war 2.54 mm	HU-11 war 2.54 mm	WF-03R war 2.54 mm	WF-07R war 2.54 mm	WF-11R war 2.54 mm	WF-15 war 2.54 mm	HU-04 war 2.54 mm	HU-12 war 2.54 mm	WF-04 war 2.54 mm	WF-08 war 2.54 mm	WF-12 war 2.54 mm	WF-15R war 2.54 mm	HU-05 war 2.54 mm	HU-13 war 2.54 mm	WF-04R war 2.54 mm	WF-08R war 2.54 mm	WF-12R war 2.54 mm	WF-15S	HU-06 war 2.54 mm	HU-14 war 2.54 mm	WF-05 war 2.54 mm	WF-09 war 2.54 mm	WF-13 war 2.54 mm	WF-16 war 2.54 mm	HU-07 war 2.54 mm	HU-15 war 2.54 mm	WF-05R war 2.54 mm	WF-09R war 2.54 mm	WF-13R war 2.54 mm	WF-16R war 2.54 mm	HU-08 war 2.54 mm	HU-16 war 2.54 mm
WF-02 war 2.54 mm	WF-06 war 2.54 mm	WF-10 war 2.54 mm	WF-14 war 2.54 mm	WF-16S	HU-09 war 2.54 mm																																																						
WF-02R war 2.54 mm	WF-06R war 2.54 mm	WF-10R war 2.54 mm	WF-14R war 2.54 mm	HU-02 war 2.54 mm	HU-10 war 2.54 mm																																																						
WF-03 war 2.54 mm	WF-07 war 2.54 mm	WF-11 war 2.54 mm	WF-14S	HU-03 war 2.54 mm	HU-11 war 2.54 mm																																																						
WF-03R war 2.54 mm	WF-07R war 2.54 mm	WF-11R war 2.54 mm	WF-15 war 2.54 mm	HU-04 war 2.54 mm	HU-12 war 2.54 mm																																																						
WF-04 war 2.54 mm	WF-08 war 2.54 mm	WF-12 war 2.54 mm	WF-15R war 2.54 mm	HU-05 war 2.54 mm	HU-13 war 2.54 mm																																																						
WF-04R war 2.54 mm	WF-08R war 2.54 mm	WF-12R war 2.54 mm	WF-15S	HU-06 war 2.54 mm	HU-14 war 2.54 mm																																																						
WF-05 war 2.54 mm	WF-09 war 2.54 mm	WF-13 war 2.54 mm	WF-16 war 2.54 mm	HU-07 war 2.54 mm	HU-15 war 2.54 mm																																																						
WF-05R war 2.54 mm	WF-09R war 2.54 mm	WF-13R war 2.54 mm	WF-16R war 2.54 mm	HU-08 war 2.54 mm	HU-16 war 2.54 mm																																																						
DRAWING TYPE		CUSTOMER																																																									
SCALE		1:1	SHEET	1 OF 1																																																							
DRAWING NO.		C-DS1070-XXXXX																																																									